

**CLASS D**

**NOTES:**

- WRITTEN DIMENSIONS ON THESE DRAWINGS SHALL HAVE PRECEDENCE OVER SCALED DIMENSIONS.
- CONTRACTOR/SUPPLIER SHALL VERIFY AND BE RESPONSIBLE FOR ALL DIMENSIONS AND CONDITIONS OF THE JOB.
- PMED MUST BE NOTIFIED IMMEDIATELY OF ANY VARIATIONS FROM THE DIMENSIONS AND CONDITIONS SHOWN IN THESE DRAWINGS.
- CONTRACTOR/SUPPLIER SHALL SUBMIT SHOP DRAWING AND PROTOTYPE TO PMED FOR APPROVAL BEFORE PRODUCTION.
- SUPPLIER TO SUBMIT FIVE (5) YEARS WARRANTY CERTIFICATE AGAINST ANY DEFECT IN PRODUCT AND WORKMANSHIP.

**SPECIFICATIONS:**

- |  |  |
|--|--|
| 01 - ALUMINUM TOP / END CAP                | 07 - CORNER CONNECTOR POST             |
| 02 - WORK TOP / COUNTER TOP                | 08 - BASE COVER / RACEWAY              |
| 03 - FABRIC PANEL (MID-PANEL)              | 09 - GROMMET CAP                       |
| 04 - PERFORATED METAL PANEL (BOTTOM PANEL) | 10 - HEAVY DUTY ADJUSTABLE FOOT GLIDES |
| 05 - ADJUSTABLE HANG SHELF (FOR PRINTERS)  | 11 - CONVENIENCE OUTLET                |
| 06 - END SUPPORT PANEL                     |  |

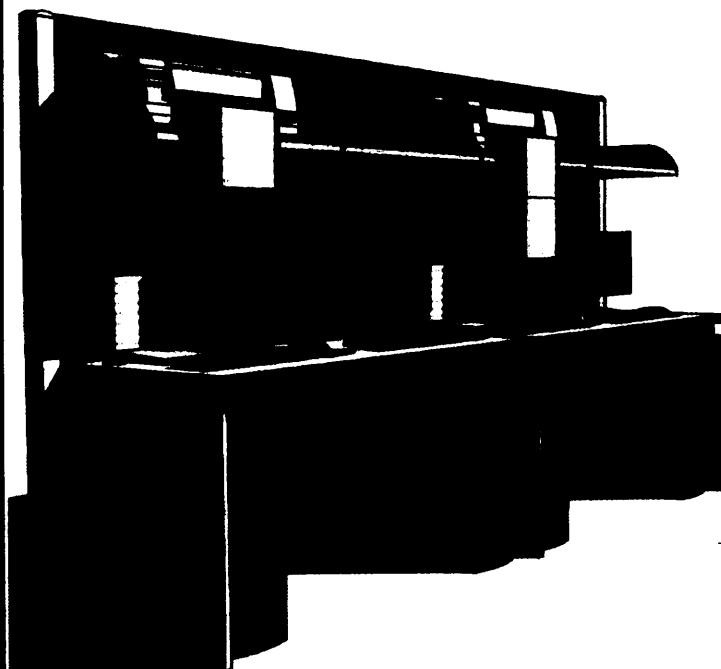

**PERSPECTIVE**

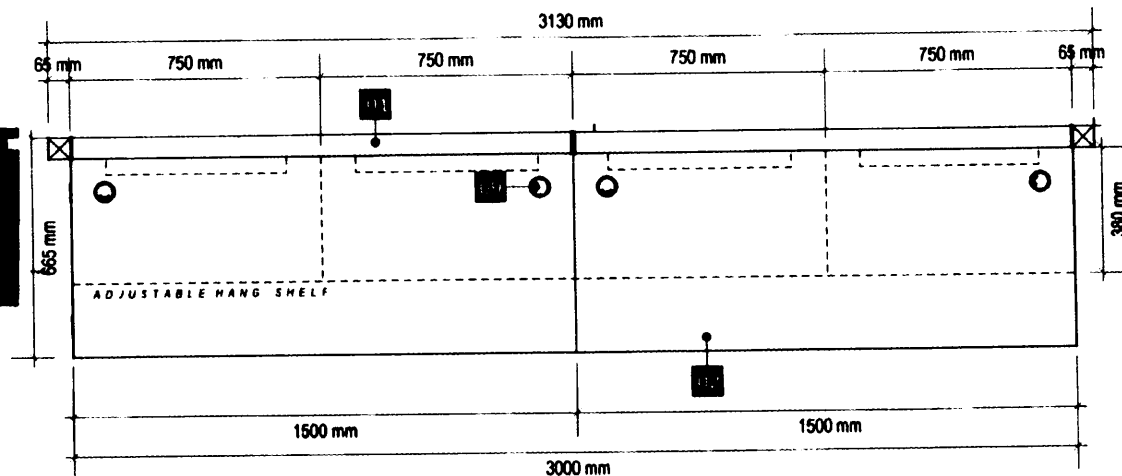

**PLAN**



**LAND BANK OF THE PHILIPPINES  
PROJECT MANAGEMENT & ENGINEERING DEPT.**

1508 M.H. DEL PILAR ST., CORNER DR. QUINTOS ST., MALATE MANILA

**TITLE:**

**COMPUTER COUNTER**

LANDBANK STANDARD DETAILS & SPECIFICATIONS

**RECOMMENDING APPROVAL:**

*[Signature]*  
ENRICO D.J. SAMANIEGO  
HEAD, PMED

**DESIGN:** TSU-PMED

**DRAWN:** TSU-PMED

**DATE:** JULY 2020

**REVIEWED:** J. MISLANG

**DATE:**

**SHEET NO:**

**CC  
10F5**

## NOTES:

- WRITTEN DIMENSIONS ON THESE DRAWINGS SHALL HAVE PRECEDENCE OVER SCALED DIMENSIONS.
- CONTRACTOR/SUPPLIER SHALL VERIFY AND BE RESPONSIBLE FOR ALL DIMENSIONS AND CONDITIONS OF THE JOB.
- **PMED** MUST BE NOTIFIED IMMEDIATELY OF ANY VARIATIONS FROM THE DIMENSIONS AND CONDITIONS SHOWN IN THESE DRAWINGS.
- CONTRACTOR/SUPPLIER SHALL SUBMIT SHOP DRAWING AND PROTOTYPE TO **PMED** FOR APPROVAL BEFORE PRODUCTION.
- SUPPLIER TO SUBMIT FIVE (5) YEARS WARRANTY CERTIFICATE AGAINST ANY DEFECT IN PRODUCT AND WORKMANSHIP.

## SPECIFICATIONS:

- |  |  |
|--|--|
| 01 - ALUMINUM TOP / END CAP                | 07 - CORNER CONNECTOR POST             |
| 02 - WORK TOP / COUNTER TOP                | 08 - BASE COVER / RACEWAY              |
| 03 - FABRIC PANEL (MID-PANEL)              | 09 - GROMMET CAP                       |
| 04 - PERFORATED METAL PANEL (BOTTOM PANEL) | 10 - HEAVY DUTY ADJUSTABLE FOOT GLIDES |
| 05 - ADJUSTABLE HANG SHELF (FOR PRINTERS)  | 11 - CONVENIENCE OUTLET                |
| 06 - END SUPPORT PANEL                     |  |

**CLASS D**

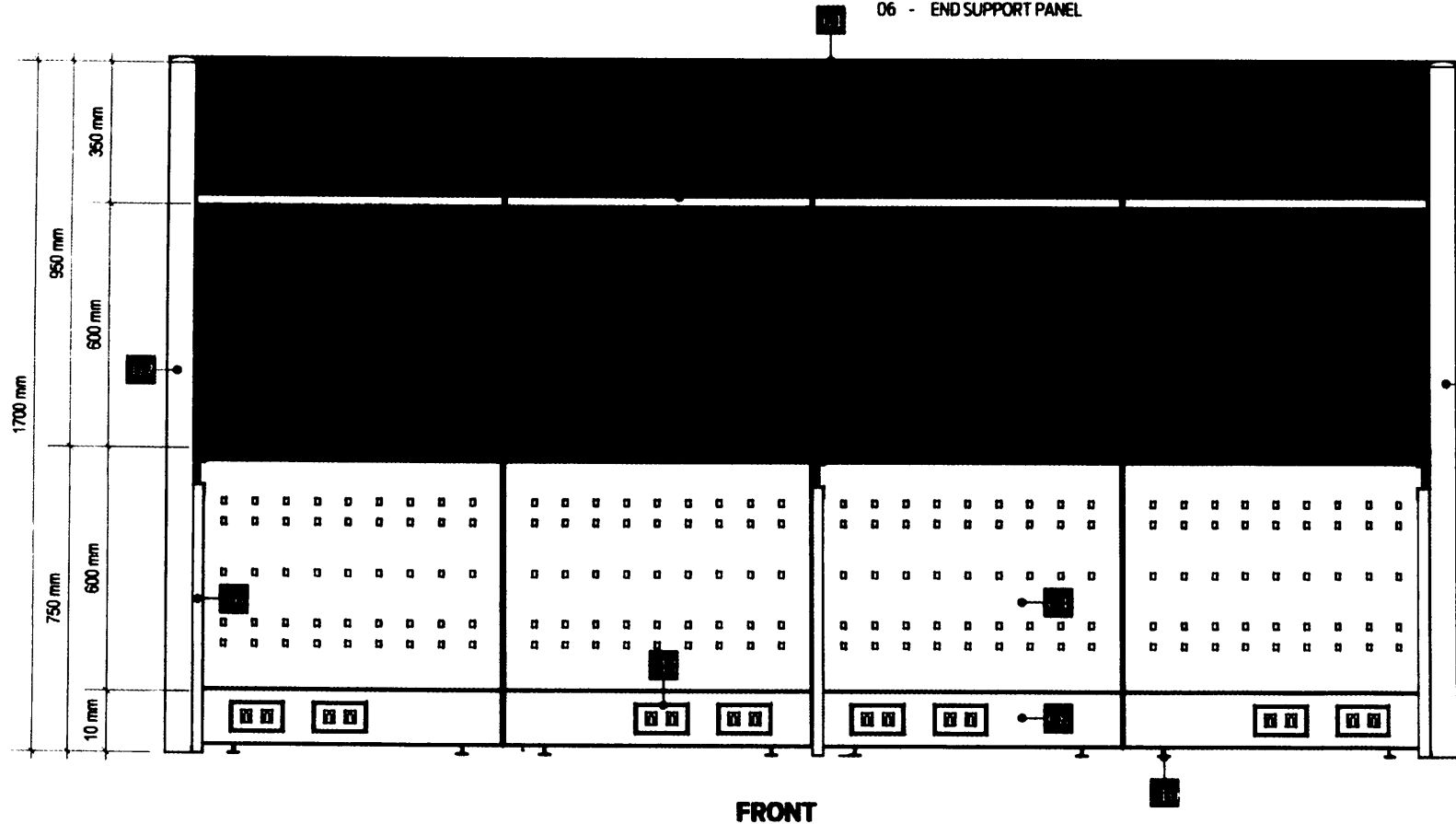

**LAND BANK OF THE PHILIPPINES  
PROJECT MANAGEMENT & ENGINEERING DEPT.**

1500 M.H. DEL PILAR ST., CORNER DR. QUINTOS ST., MALATE MANILA

TITLE:

**COMPUTER COUNTER**

LANDBANK STANDARD DETAILS & SPECIFICATIONS

RECOMMENDING APPROVAL:

*[Signature]*  
ENRICO D.J. SAMANIEGO  
HEAD, PMED

DESIGN: TSU-PMED

DRAWN: TSU-PMED

DATE: JULY 2020

REVIEWED: J. MISLANG

DATE:

SHEET NO:

**CC  
2 OF 5**

65-D

## NOTES:

- WRITTEN DIMENSIONS ON THESE DRAWINGS SHALL HAVE PRECEDENCE OVER SCALED DIMENSIONS.
- CONTRACTOR/SUPPLIER SHALL VERIFY AND BE RESPONSIBLE FOR ALL DIMENSIONS AND CONDITIONS OF THE JOB.
- **PMED** MUST BE NOTIFIED IMMEDIATELY OF ANY VARIATIONS FROM THE DIMENSIONS AND CONDITIONS SHOWN IN THESE DRAWINGS.
- CONTRACTOR/SUPPLIER SHALL SUBMIT SHOP DRAWING AND PROTOTYPE TO **PMED** FOR APPROVAL BEFORE PRODUCTION.
- SUPPLIER TO SUBMIT FIVE (5) YEARS WARRANTY CERTIFICATE AGAINST ANY DEFECT IN PRODUCT AND WORKMANSHIP.

## SPECIFICATIONS:

- |  |  |
|--|--|
| 01 - ALUMINUM TOP / END CAP                | 07 - CORNER CONNECTOR POST             |
| 02 - WORK TOP / COUNTER TOP                | 08 - BASE COVER / RACEWAY              |
| 03 - FABRIC PANEL (MID-PANEL)              | 09 - GROMMET CAP                       |
| 04 - PERFORATED METAL PANEL (BOTTOM PANEL) | 10 - HEAVY DUTY ADJUSTABLE FOOT GLIDES |
| 05 - ADJUSTABLE HANG SHELF (FOR PRINTERS)  | 11 - CONVENIENCE OUTLET                |
| 06 - END SUPPORT PANEL                     |  |

**CLASS D**

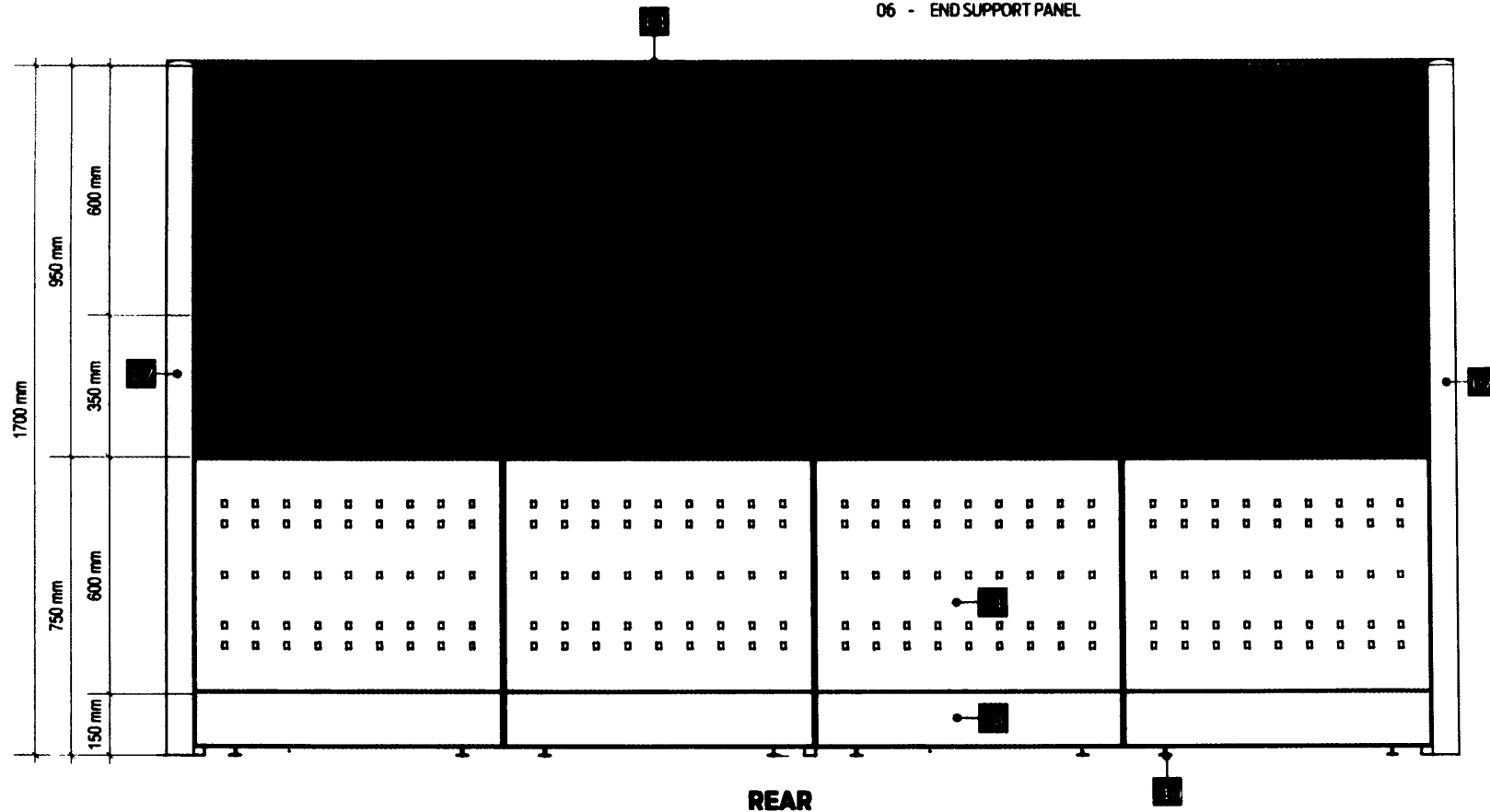

**LAND BANK OF THE PHILIPPINES  
PROJECT MANAGEMENT & ENGINEERING DEPT.**

1508 M.H. DEL PILAR ST., CORNER DR. QUINTOS ST., MALATE MANILA

TITLE:

**COMPUTER COUNTER**

LANDBANK STANDARD DETAILS & SPECIFICATIONS

RECOMMENDING APPROVAL:

*[Signature]*  
**ENICO D.J. SAMARINO**  
HEAD, PMED

DESIGN: TSU-PMED

DRAWN: TSU-PMED

DATE: JULY 2020

REVIEWED: J. MISLANG

DATE:

SHEET NO:

**CC  
3 OF 5**

D-57

## NOTES:

- WRITTEN DIMENSIONS ON THESE DRAWINGS SHALL HAVE PRECEDENCE OVER SCALED DIMENSIONS.
- CONTRACTOR/SUPPLIER SHALL VERIFY AND BE RESPONSIBLE FOR ALL DIMENSIONS AND CONDITIONS OF THE JOB.
- PMED MUST BE NOTIFIED IMMEDIATELY OF ANY VARIATIONS FROM THE DIMENSIONS AND CONDITIONS SHOWN IN THESE DRAWINGS.
- CONTRACTOR/SUPPLIER SHALL SUBMIT SHOP DRAWING AND PROTOTYPE TO PMED FOR APPROVAL BEFORE PRODUCTION.
- SUPPLIER TO SUBMIT FIVE (5) YEARS WARRANTY CERTIFICATE AGAINST ANY DEFECT IN PRODUCT AND WORKMANSHIP.

## SPECIFICATIONS:

- |  |  |
|--|--|
| 01 - ALUMINUM TOP / END CAP                | 07 - CORNER CONNECTOR POST             |
| 02 - WORK TOP / COUNTER TOP                | 08 - BASE COVER / RACEWAY              |
| 03 - FABRIC PANEL (MID-PANEL)              | 09 - GROMMET CAP                       |
| 04 - PERFORATED METAL PANEL (BOTTOM PANEL) | 10 - HEAVY DUTY ADJUSTABLE FOOT GLIDES |
| 05 - ADJUSTABLE HANG SHELF (FOR PRINTERS)  | 11 - CONVENIENCE OUTLET                |
| 06 - END SUPPORT PANEL                     |  |

**CLASS D**

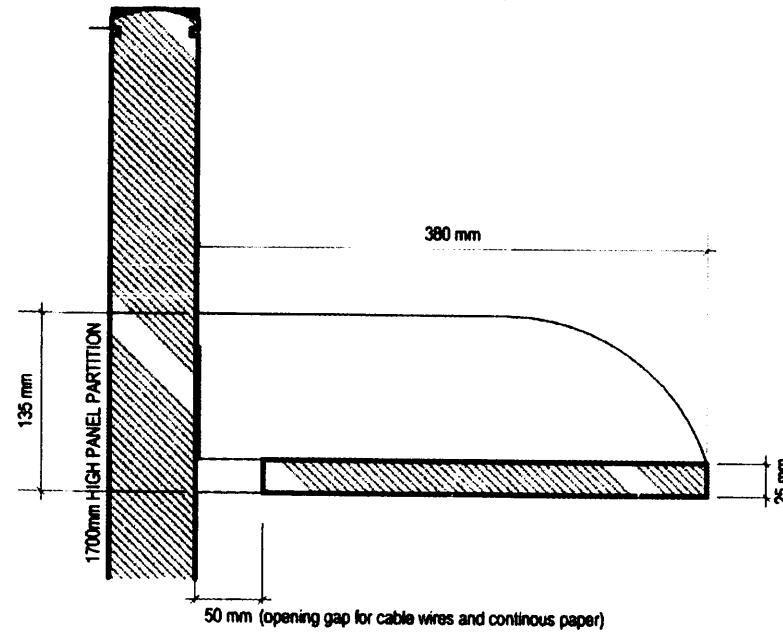
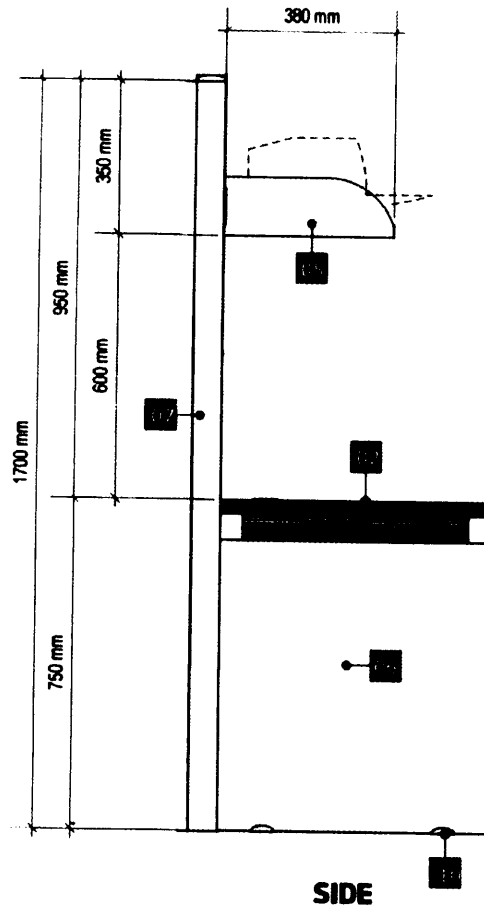

**LAND BANK OF THE PHILIPPINES**  
**PROJECT MANAGEMENT & ENGINEERING DEPT.**  
 1508 M.H. DEL PILAR ST., CORNER DR. QUINTOS ST., MALATE MANILA

TITLE:

**COMPUTER COUNTER**

LANDBANK STANDARD DETAILS & SPECIFICATIONS

RECOMMENDING APPROVAL:

*[Signature]*  
 ENCO D.J. SAMPANEGO  
 HEAD, PMED

DESIGN: TSU-PMED

DRAWN: TSU-PMED

DATE: JULY 2020

REVIEWED: J. MISLANG

DATE:

SHEET NO:

**CC**  
**4 OF 5**

D-58

**DESCRIPTIONS**

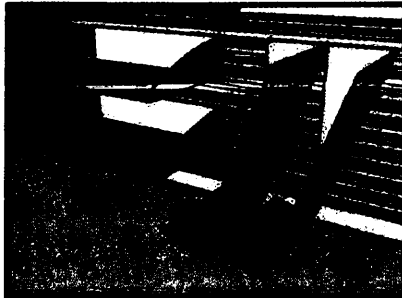

IN AND OUT TRAYS

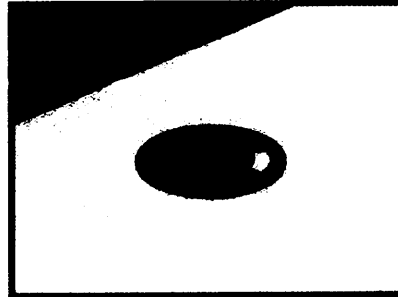

GROMMET CAP

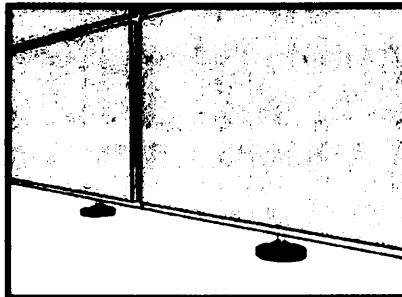

HEAVY DUTY ADJUSTABLE FOOT GLIDES

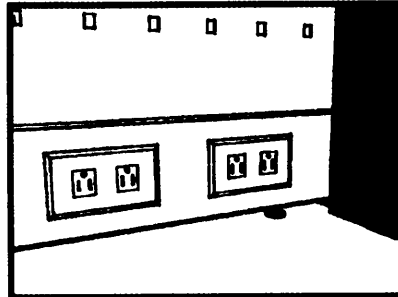

RACEWAY

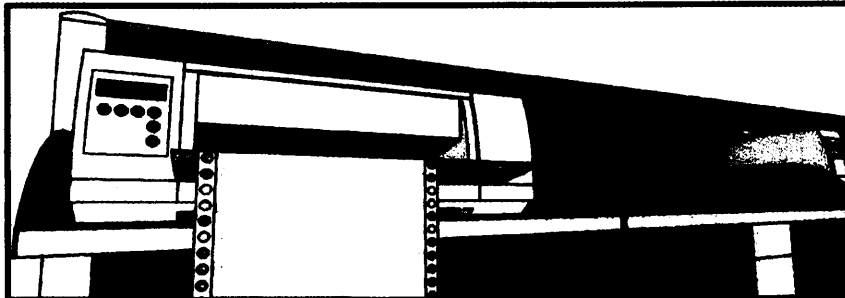

HANGING SHELVES (FOR PRINTER)

- PANEL SYSTEM:**  
 -FOR SEGMENTED AND COMPOSITE PANELS INCLUDING THE ELECTRICAL AND DATA PORT ACCESS.
- HEIGHT:**  
 -OVER-ALL PANEL HEIGHT SHALL BE 1700mm. (SEE ATTACHED LAYOUT)
- WIDTH:**  
 -WIDTH RANGING FROM 600mm, 750mm, and 1500mm. (SEE ATTACHED LAYOUT)
- THICKNESS:**  
 -PANEL THICKNESS SHALL BE GA. 16 COLD ROLLED METAL WITH A MINIMUM OF 62.5mm THK TO 75mm THK.
- FABRIC (TOP/MID PANEL):**  
 -PANEL FABRIC SURFACE AREA SHOULD BE REMOVABLE AND CAN FIT BACK IN PLACE.  
 -ASSEMBLED THROUGH CLIP-ON CONNECTION WITH 6mm THK MDF TILE BACKING.  
 -FABRIC COLOR : GRAY (SUBJECT FOR APPROVAL)
- PERFORATED METAL (BOTTOM PANEL):**  
 -METAL PANEL SHALL BE GA. 18 METAL SHEET ON POWDER COATED FINISH.  
 -PANEL COLOR : GRAY (SUBJECT FOR APPROVAL)
- FRAMES:**  
 -FRAMES SHALL BE GA. 18 (MIN) COLD ROLLED SHEET WITH NON-CORROSIVE PAINT FINISH.  
 -FABRICATION SHALL BE LIGHTWEIGHT WITH FINE DETAILS.  
 -COLOR: GRAY (SUBJECT FOR APPROVAL)
- CAPPING AND END TRIMS:**  
 -CAPPING SHALL BE ALUMINIUM ON POWDER COATED FINISH.  
 -PROVIDE HEAVY DUTY FOOT GLIDES FOR ALL PARTITIONS.  
 -COLOR : GRAY (SUBJECT FOR APPROVAL)
- METAL GRILLE PANEL:**  
 -PANEL SHALL BE GA. 18 (MIN) COLD ROLLED SHEET ON POWDER COATED FINISH.  
 -PROVIDE SLOTS FOR IN AND OUT TRAYS.  
 -COLOR : GRAY (SUBJECT FOR APPROVAL)
- RACEWAY:**  
 -SHOULD BE ABLE TO ACCOMMODATE A MAXIMUM OF TEN (10) WIRES AND TEN (10) CABLES.  
 -RACEWAY HEIGHT RANGING FROM 150mm TO 200mm.  
 -INCLUDE PROVISIONS FOR TWO (2) UNIVERSAL CONVENIENCE OUTLETS, ONE (1) DATA OULET, AND ONE (1) SPARE OULET FOR EVERY PANEL.
- IN AND OUT TRAYS:**  
 -TRAYS SHALL BE GA. 18 COLD ROLLED METAL SHEET ON POWDER COATED FINISH.  
 -TRAY SLOTS TO BE FIRMLY ATTACHED TO METAL GRILLE FRAME.  
 -COLOR : GRAY (SUBJECT FOR APPROVAL)
- WORK SURFACE:**  
 -32mm THK MDF, HDF OR EQUIVALENT WITH 1.5mm THK HIGH PRESSURE LAMINATE (HPL) WITH T-MOULDING EDGES  
 -COLOR: LIGHT BEIGE (SUBJECT FOR APPROVAL)
- ADJUSTABLE SHELF:**  
 -GA. 18 FORMED STEEL FULLY WELDED ASSEMBLY ON POWDER COATED FINISH  
 -COLOR : GRAY (SUBJECT FOR APPROVAL)

**ACCESSORIES**



**LAND BANK OF THE PHILIPPINES**  
**PROJECT MANAGEMENT & ENGINEERING DEPT.**  
 1508 M.H. DEL PILAR ST., CORNER DR. QUINTOS ST., MALATE MANILA

TITLE:

**COMPUTER COUNTER**

LANDBANK STANDARD DETAILS & SPECIFICATIONS

RECOMMENDING APPROVAL:

*[Signature]*  
 J. MISLANG  
 HEAD, PMED

DESIGN: TSU-PMED

DRAWN: TSU-PMED

DATE: JULY 2020

REVIEWED: J. MISLANG

DATE:

SHEET NO:

**CC**  
**50F5**

D-59

**CLASS D**

**SPECIAL CLIENTS TABLE**

**GENERAL NOTES /**

**TERMS OF REFERENCE:**

- SUPPLIER TO SUBMIT A WARRANTY CERTIFICATE OF ONE (1) YEAR AGAINST ANY DEFECT IN PRODUCT AND WORKMANSHIP.
- SUPPLIER TO SUBMIT DETAILED DRAWINGS PRINTED ON A4 SIZE PAPER WITH THE SUPPLIER'S OFFICIAL LETTERHEAD AND MOCK-UP UNIT TO PMED FOR POST QUALIFICATION EVALUATION.
- WRITTEN DIMENSION ON THE DRAWINGS SHALL HAVE PRECEDENCE OVER SCALED DIMENSIONS.
- SUPPLIER SHALL VERIFY AND BE RESPONSIBLE FOR ALL DIMENSIONS AND CONDITIONS ON THE JOB.
- DISCREPANCIES BETWEEN DRAWINGS AND ACTUAL CONDITION MUST BE IMMEDIATELY FORWARDED TO PMED FOR RESOLUTION.
- SUPPLIER VERIFY AND BE RESPONSIBLE FOR ALL DIMENSIONS AND CONDITIONS OF THE JOB.
- SUPPLIER TO COORDINATE WITH THE END-USER ON THE SCHEDULE OF MOBILIZATION/DELIVERY OF THE SAID ITEM.
- SUPPLIER TO SUBMIT (AS PART OF THE DOCUMENTARY REQUIREMENTS) TO PMED THE PHOTOS OF ACTUAL INSTALLED ITEMS. (CLOSE-UP AND FULL VIEW OF THE SAID ITEM)

**TECHNICAL SPECIFICATIONS**

- 1000mm. DIA. x 32mm THK. HDF/MDF TABLE WITH 1.5mm THK. HPL TABLE TOP  
COLOR: OFF-WHITE (SUBJECT FOR APPROVAL)
- TABLE EDGES SHOULD BE TORUS AND PROVIDED WITH RUBBER OR PLASTIC EDGE MOULDING  
COLOR: BLACK
- 8mm THK. POWDER-COATED STEEL BASE  
COLOR: BLACK

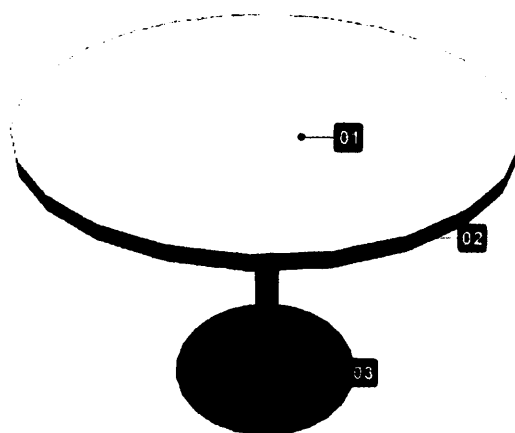

**PERSPECTIVE**

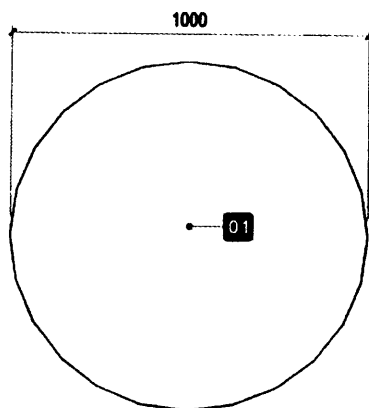

**PLAN**

SCALE 1:20

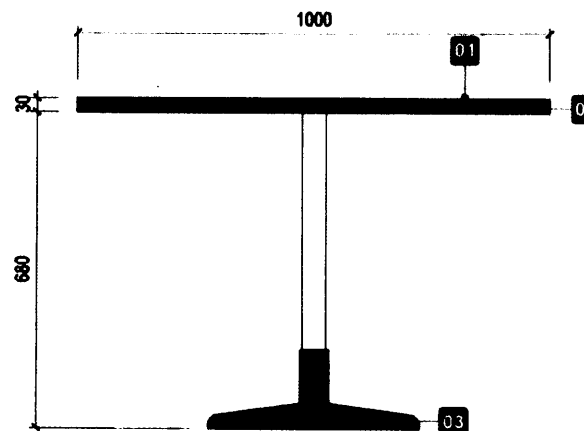

**ELEVATION**

SCALE: 1:15

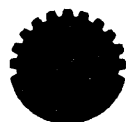

**LAND BANK OF THE PHILIPPINES**  
PROJECT MANAGEMENT & ENGINEERING DEPT.  
1500 M.H. DEL PILAR ST. CORNER DR. QUINTOS ST. MALATE, MANILA

PROJECT TITLE:

**SPECIAL CLIENTS TABLE  
(ROUND)**

LANDBANK STANDARD DETAILS AND SPECIFICATIONS

APPROVED BY:

*[Signature]*  
**ENRICO D.J. SARMANIEGO**  
HEAD, PMED

SHEET CONTENTS:

PERSPECTIVE  
PLAN VIEW  
SPECIFICATION

DESIGN PMED-TSU

DRAWN NESB

DATE DEC 2020

CHECKED J. MISLANG

SHEET NO:

**A-1**

4-8CT-18

D-60

## NOTES:

- WRITTEN DIMENSIONS ON THESE DRAWINGS SHALL HAVE PRECEDENCE OVER SCALED DIMENSIONS.
- CONTRACTOR/SUPPLIER SHALL VERIFY AND BE RESPONSIBLE FOR ALL DIMENSIONS AND CONDITIONS OF THE JOB.
- DISCREPANCIES BETWEEN DRAWINGS AND ACTUAL CONDITION MUST BE IMMEDIATELY FORWARDED TO PMED FOR RESOLUTION.
- SUPPLIER SHALL SUBMIT SHOP DRAWINGS TO PMED FOR APPROVAL PRIOR TO FABRICATION.
- SUPPLIER TO SUBMIT FIVE (5) YEARS WARRANTY CERTIFICATE AGAINST DEFECT IN PRODUCT AND WORKMANSHIP.
- SUPPLIER TO COORDINATE WITH THE END-USER ON THE SCHEDULE OF MOBILIZATION/ DELIVERY.

**CLASS D**

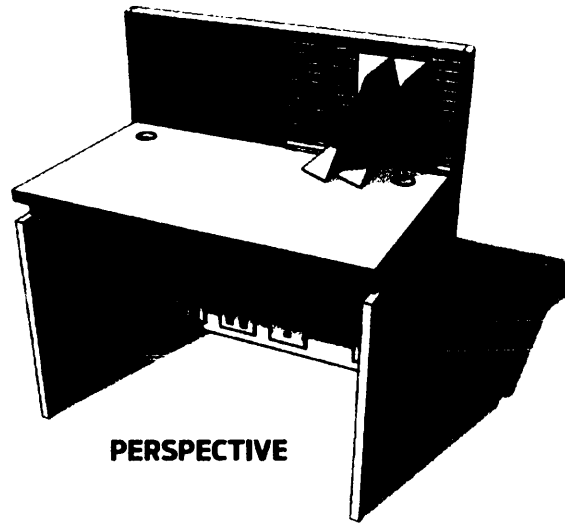

**PERSPECTIVE**

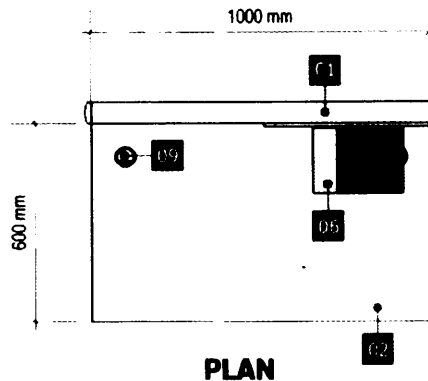

**PLAN**

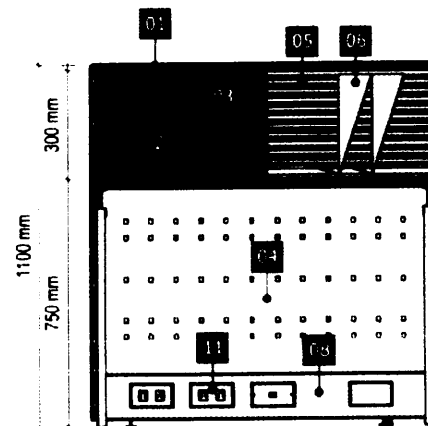

**FRONT**

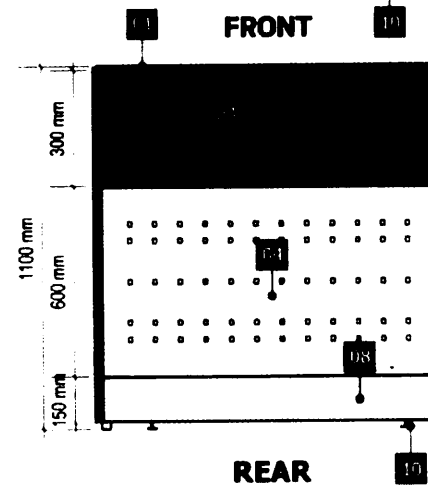

**REAR**

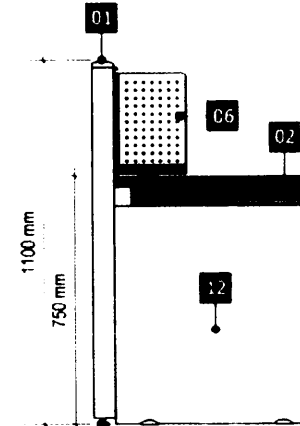

**LEFT SIDE**

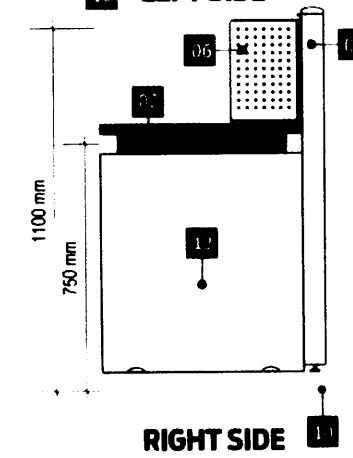

**RIGHT SIDE**

## SPECIFICATIONS:

- 01 - ALUMINUM TOP / END CAP
- 02 - WORK TOP / COUNTER TOP
- 03 - FABRIC PANEL (TOP PANEL)
- 04 - PERFORATED METAL PANEL (BOTTOM PANEL)
- 05 - METAL GRILLE PANEL (FOR IN-AND-OUT TRAYS)
- 06 - METAL IN-AND-OUT TRAYS
- 07 - END SUPPORT PANEL
- 08 - BASE COVER / RACEWAY
- 09 - GROMMET CAP
- 10 - HEAVY DUTY ADJUSTABLE FOOT GLIDES
- 11 - PROVISION FOR CONVENIENCE, DATA AND SPARE OUTLET
- 12 - MODESTY PANEL



**LAND BANK OF THE PHILIPPINES  
PROJECT MANAGEMENT & ENGINEERING DEPT.**

1500 M.H. DEL PILAR ST. CORNER DR. QUINTOS ST. MALATE MANILA

TITLE:

**CLERICAL WORKSTATION  
1.0 M  
(CUSTOMIZED)**

LANDBANK STANDARD DETAILS & SPECIFICATIONS

RECOMMENDING APPROVAL:

*[Signature]*  
**EMILIO D. SAMARINO**  
HEAD, PMED

DESIGN: TSU-PMED

DRAWN: NESS

DATE: JULY 2020

REVIEWED: J. MISLANG

DATE:

SHEET NO:

**CW1.0  
1 OF 2**

D-61

## NOTES:

- WRITTEN DIMENSIONS ON THESE DRAWINGS SHALL HAVE PRECEDENCE OVER SCALED DIMENSIONS.
- CONTRACTOR/SUPPLIER SHALL VERIFY AND BE RESPONSIBLE FOR ALL DIMENSIONS AND CONDITIONS OF THE JOB.
- DISCREPANCIES BETWEEN DRAWINGS AND ACTUAL CONDITION MUST BE IMMEDIATELY FORWARDED TO PMED FOR RESOLUTION.
- SUPPLIER SHALL SUBMIT SHOP DRAWINGS TO PMED FOR APPROVAL PRIOR TO FABRICATION.
- SUPPLIER TO SUBMIT FIVE (5) YEARS WARRANTY CERTIFICATE AGAINST DEFECT IN PRODUCT AND WORKMANSHIP.
- SUPPLIER TO COORDINATE WITH THE END-USER ON THE SCHEDULE OF MOBILIZATION/ DELIVERY.

**CLASS D**



GROMMET CAP

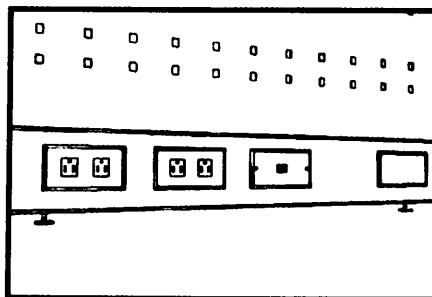

RACEWAY

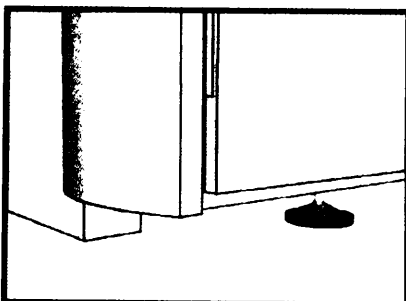

HEAVY DUTY ADJUSTABLE FOOT GLIDES

## ACCESSORIES

## DESCRIPTIONS

### PANEL SYSTEM:

-FOR SEGMENTED AND COMPOSITE PANELS INCLUDING THE ELECTRICAL AND DATA PORT ACCESS.

### HEIGHT:

-OVER-ALL PANEL HEIGHT SHALL BE 1100mm. (SEE ATTACHED LAYOUT)

### WIDTH:

-WIDTH RANGING FROM 600mm and 1000mm. (SEE ATTACHED LAYOUT)

### THICKNESS:

-PANEL THICKNESS SHALL BE GA. 16 COLD ROLLED METAL WITH A MINIMUM OF 62.5mm THK TO 75mm THK.

### FABRIC (TOP PANEL):

-PANEL FABRIC SURFACE AREA SHOULD BE REMOVABLE AND CAN FIT BACK IN PLACE.

-ASSEMBLED THROUGH CLIP-ON CONNECTION WITH 6mm THK MDF TILE BACKING.

-FABRIC COLOR: GRAY (SUBJECT FOR APPROVAL)

### PERFORATED METAL (BOTTOM PANEL):

-METAL PANEL SHALL BE GA. 18 METAL SHEET ON POWDER COATED FINISH.

-PANEL COLOR: GRAY (SUBJECT FOR APPROVAL)

### FRAMES:

-FRAMES SHALL BE GA. 18 (MIN) COLD ROLLED SHEET WITH NON-CORROSIVE PAINT FINISH.

-FABRICATION SHALL BE LIGHTWEIGHT WITH FINE DETAILS.

-COLOR: GRAY (SUBJECT FOR APPROVAL)

### CAPPING AND END TRIMS:

-CAPPING SHALL BE ALUMINUM ON POWDER COATED FINISH.

-PROVIDE HEAVY DUTY FOOT GLIDES FOR ALL PARTITIONS.

-COLOR: GRAY (SUBJECT FOR APPROVAL)

### RACEWAY:

-SHOULD BE ABLE TO ACCOMMODATE A MAXIMUM OF TEN (10) WIRES AND TEN (10) CABLES.

-RACEWAY HEIGHT RANGING FROM 150mm TO 200mm.

-INCLUDE PROVISIONS FOR TWO (2) UNIVERSAL CONVENIENCE OUTLETS, ONE (1) DATA OUTLET, AND ONE (1) SPARE OUTLET FOR EVERY PANEL.

### WORK SURFACE:

-32mm THK MDF, HDF OR EQUIVALENT WITH 1.5mm THK HIGH PRESSURE LAMINATE (HPL) WITH T-MOULDING EDGES

-COLOR: LIGHT BEIGE (SUBJECT FOR APPROVAL)



**LAND BANK OF THE PHILIPPINES  
PROJECT MANAGEMENT & ENGINEERING DEPT.**

1598 M.H. DEL PILAR ST. CORNER DR. QUINTOS ST. MALATE MANILA

TITLE:

**CLERICAL WORKSTATION  
1.0 M  
(CUSTOMIZED)**

LANDBANK STANDARD DETAILS & SPECIFICATIONS

RECOMMENDING APPROVAL:

*[Signature]*  
**ENRICO D.J. SAMANINGO**  
HEAD, PMED

DESIGN: TSU-PMED

DRAWN: NESS

DATE: JULY 2020

REVIEWED: J. MISLANG

DATE:

SHEET NO:

**CW1.0  
2 OF 2**



# NOTES:

- WRITTEN DIMENSIONS ON THESE DRAWINGS SHALL HAVE PRECEDENCE OVER SCALED DIMENSIONS.
- CONTRACTOR/SUPPLIER SHALL VERIFY AND BE RESPONSIBLE FOR ALL DIMENSIONS AND CONDITIONS OF THE JOB
- DISCREPANCIES BETWEEN DRAWINGS AND ACTUAL CONDITION MUST BE IMMEDIATELY FORWARDED TO PMED RESOLUTION

CLASS D



PERSPECTIVE

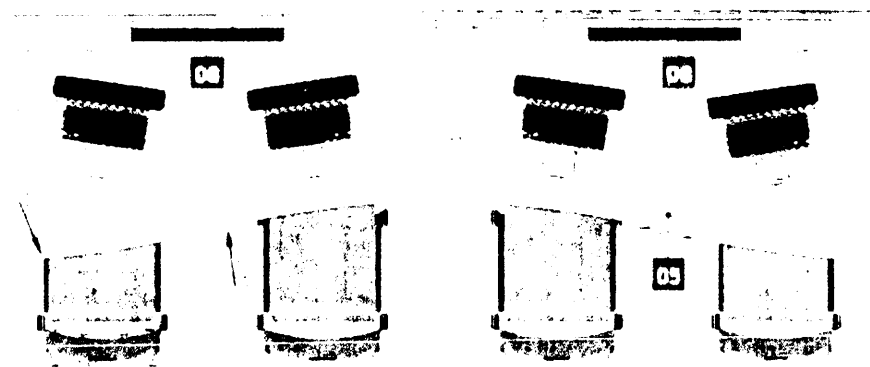

TOP VIEW

## DESCRIPTION/ SPECIFICATIONS:

- 01 - 1/2" THICK CLEAR ACRYLIC BOARD, BACK COAT WITH PRINTED LANDBANK LOGO AND LANDBANK AND DIGITAL BANKING CORNER TEXT WITH 3D SHADOW EFFECT
- 02 - 1/4" ACRYLIC SHEET WITH REVERSE STICKER WITH LED STRIP LIGHT AT THE BOTTOM PANEL
- 03 - 1/8" WHITE GRAB LAMINATE ON 1/2" ALUMINUM WITH 1/2" LED STRIP LIGHT ON BACK
- 04 - METAL LAMINATE STRIP ACCENTS ON 1/2" ALUMINUM BOARD WITH 1/2" LED STRIP LIGHT ON BACK
- 05 - 1/4" INTERIOR METAL LAMINATE WITH HIGH RESOLUTION LAMINATE ON 1/2" ALUMINUM BOARD WITH 1/2" LED STRIP LIGHT ON BACK
- 06 - 1/4" ALUMINUM EXTRUSION WITH 1/2" LED STRIP LIGHT ON BACK
- 07 - 1/4" ALUMINUM EXTRUSION WITH 1/2" LED STRIP LIGHT ON BACK
- 08 - 1/4" ALUMINUM EXTRUSION WITH 1/2" LED STRIP LIGHT ON BACK

## APPROVED BY:

*[Signature]*  
EVP JULIO D. CLIMACO JR.  
HEAD BBS



LANDBANK OF THE PHILIPPINES  
PROJECT MANAGEMENT & ENGINEERING DEPT

TITLE

DIGITAL BANKING CORNER  
(FOR BIG BRANCH)

RECOMMENDING APPROVAL

*[Signature]*  
ENRICO D. SAMANIEGO  
HEAD PMED

DESIGN

DRAWN

DATE 26 FEBRUARY 2024

CHECKED

DATE

SHEET NO.

DBC  
1

# NOTES:

- WRITTEN DIMENSIONS ON THESE DRAWINGS SHALL HAVE PRECEDENCE OVER SCALED DIMENSIONS
- CONTRACTOR/SUPPLIER SHALL VERIFY AND BE RESPONSIBLE FOR ALL DIMENSIONS AND CONDITIONS OF THE JOB
- DISCREPANCIES BETWEEN DRAWINGS AND ACTUAL CONDITION MUST BE IMMEDIATELY FORWARDED TO PMED RESOLUTION

CLASS D



FRONT VIEW

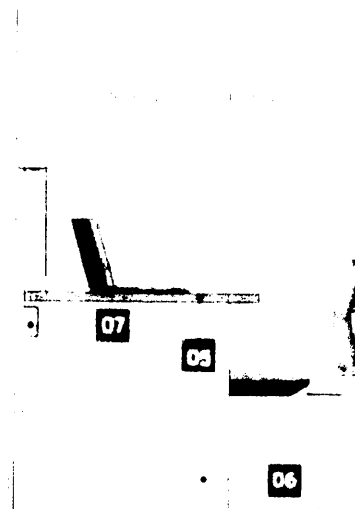

LEFT SIDE VIEW

APPROVED BY:

*Julio D. Climaco Jr.*  
EVP JULIO D. CLIMACO JR.  
HEAD BBS



LANDBANK OF THE PHILIPPINES  
PROJECT MANAGEMENT & ENGINEERING DEPT.

TITLE

DIGITAL BANKING CORNER  
( FOR BIG BRANCH )

LANDBANK STANDARD DETAILS AND SPECIFICATIONS

RECOMMENDING APPROVAL

*Samuel D. Samaniego*  
SAMUEL D. SAMANIEGO  
HEAD PMED

DESIGN

DRAWN

DATE 26 FEBRUARY 2020

CHECKED

DATE

SHEET NO.

DBC  
2

D-64

## NOTES:

- WRITTEN DIMENSIONS ON THESE DRAWINGS SHALL HAVE PRECEDENCE OVER SCALED DIMENSIONS.
- CONTRACTOR/SUPPLIER SHALL VERIFY AND BE RESPONSIBLE FOR ALL DIMENSIONS AND CONDITIONS OF THE JOB.
- DISCREPANCIES BETWEEN DRAWINGS AND ACTUAL CONDITION MUST BE IMMEDIATELY FORWARDED TO PMED RESOLUTION

**CLASS D**

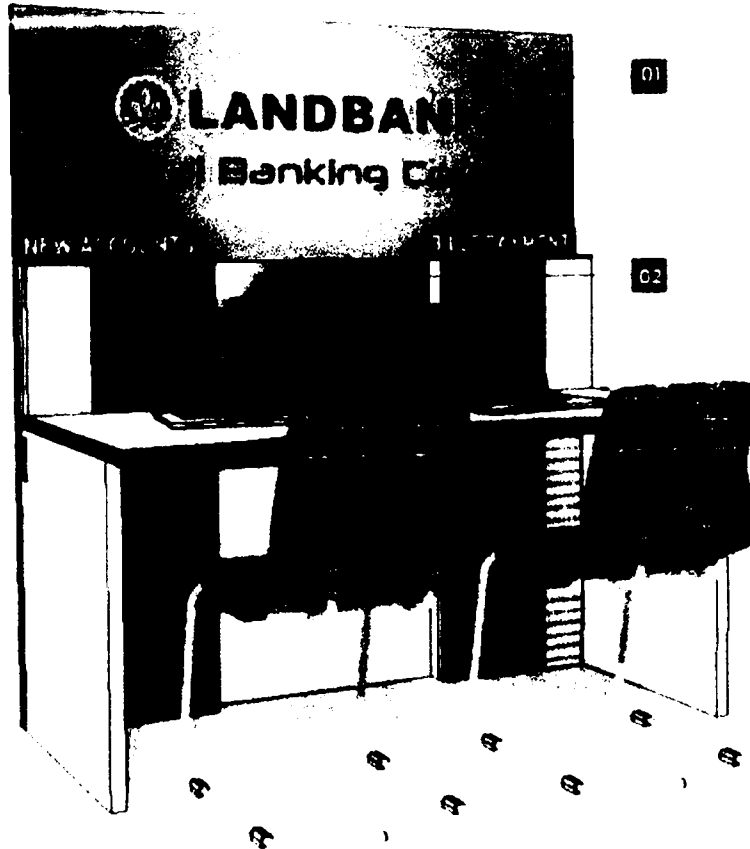

**PERSPECTIVE**

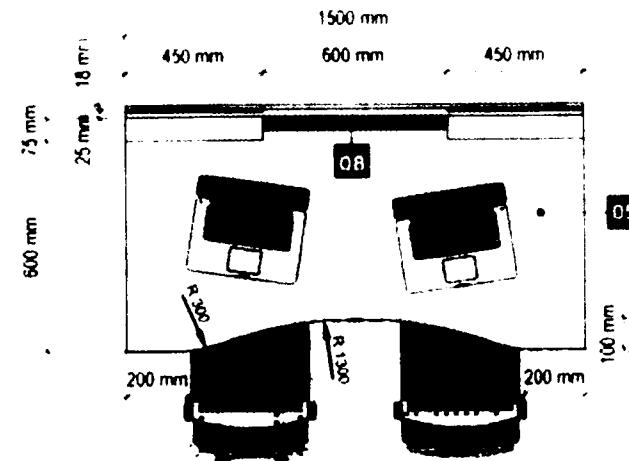

**TOP VIEW**

### DESCRIPTION/ SPECIFICATIONS:

- 01 - GOLD STICKER ON SINTRA BOARD BACK DROP WITH PRINTED 'LANDBANK LOGO', 'LANDBANK' AND 'DIGITAL BANKING CORNER' TEXT (WITH GOLD SHADOW EFFECT)
- 02 - 1/2" ACRYLIC SHEET WITH REVERSE STICKER WITH LED STRIP LIGHT AT THE BOTTOM PORTION
- 03 - HPL WOOD GRAIN LAMINATE ON 32MM MDF WITH 2MM THK PVC EDGING (COLOR: BLACK)
- 04 - METAL LAMINATE STRIP ACCENTS ON 32MM MDF BOARD WITH 2MM THK PVC EDGING (COLOR: BLACK)
- 05 - COUNTERTOP METALLIC FINISH HIGH PRESSURE LAMINATE (HPL) ON 32MM THK MDF W/ 2MM EDGING (COLOR: SILVER i.e. COSMIC DUSK OR APPROVED EQUAL)
- 06 - LEG/SIDINGS GRAY HPL ON 32MM MDF WITH 2MM THK PVC EDGING (COLOR: BLACK)
- 07 - 50mm x 100mm ALUMINUM RACEWAY
- 08 - 45mm MOHAIR (COLOR: BLACK)

APPROVED BY:

*Julio D. Climaco, Jr.*  
EVP JULIO D. CLIMACO, JR.  
HEAD, E&S

REV. 2(08-30-2019)



LANDBANK OF THE PHILIPPINES  
PROJECT MANAGEMENT & ENGINEERING DEPT.  
1598 M.H. DEL PILAR ST. CORNER DR. QUINTOS ST. MALATE MANILA

TITLE:

DIGITAL BANKING CORNER  
(FOR SMALL BRANCH)

LANDBANK STANDARD DETAILS & SPECIFICATIONS

RECOMMENDING APPROVAL:

*Julio D. Climaco, Jr.*  
EVP JULIO D. CLIMACO, JR.  
HEAD, PMED

DESIGN: TSU/PMED

DRAWN: NESS/MARC

DATE: 26 FEBRUARY 2020

CHECKED: MISLANG

DATE:

SHEET NO:

**DBC  
3**

D-65

# NOTES:

- WRITTEN DIMENSIONS ON THESE DRAWINGS SHALL HAVE PRECEDENCE OVER SCALED DIMENSIONS.
- CONTRACTOR/SUPPLIER SHALL VERIFY AND BE RESPONSIBLE FOR ALL DIMENSIONS AND CONDITIONS OF THE JOB.
- DISCREPANCIES BETWEEN DRAWINGS AND ACTUAL CONDITION MUST BE IMMEDIATELY FORWARDED TO PMED RESOLUTION

CLASS D

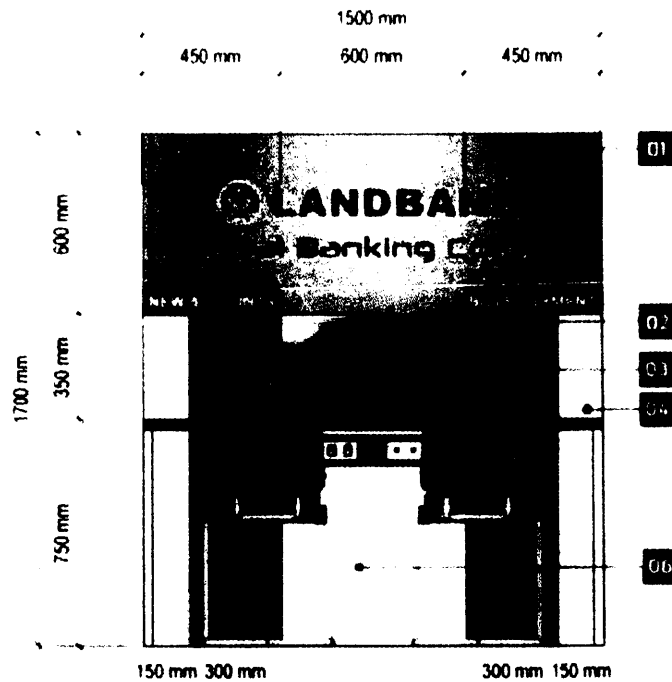

FRONT VIEW

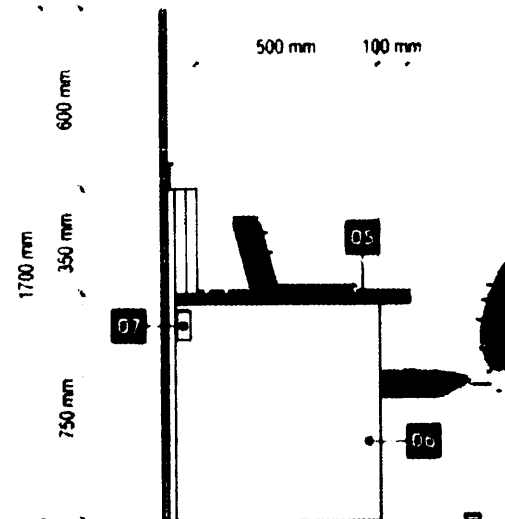

LEFT SIDE VIEW

APPROVED BY:

*Julio D. Climaco Jr.*

EVP JULIO D. CLIMACO, JR.

HEAD, BBS

REV. 2(08-30-2019)



LANDBANK OF THE PHILIPPINES  
PROJECT MANAGEMENT & ENGINEERING DEPT.

1598 M.H. DEL PILAR ST. CORNER DR. QUINTOS ST. MALATE MANILA

TITLE

DIGITAL BANKING CORNER  
(FOR SMALL BRANCH)

LANDBANK STANDARD DETAILS & SPECIFICATIONS

RECOMMENDING APPROVAL:

*Julio D. Climaco Jr.*  
EVP JULIO D. CLIMACO, JR.  
HEAD, PMED

DESIGN: TSU-PMED

DRAWN: NESSAMARC

DATE: 26 FEBRUARY 2020

CHECKED: J. MISLANG

DATE:

SHEET NO.

DBC  
4

D 44

**NOTES:**

- WRITTEN DIMENSIONS ON THESE DRAWINGS SHALL HAVE PRECEDENCE OVER SCALED DIMENSIONS.
- CONTRACTORS SHALL VERIFY AND BE RESPONSIBLE FOR ALL DIMENSIONS AND CONDITIONS ON THE JOB.
- DISCREPANCIES BETWEEN DRAWINGS AND ACTUAL CONDITION MUST BE IMMEDIATELY FORWARDED TO PMED FOR RESOLUTION.

CLASS D

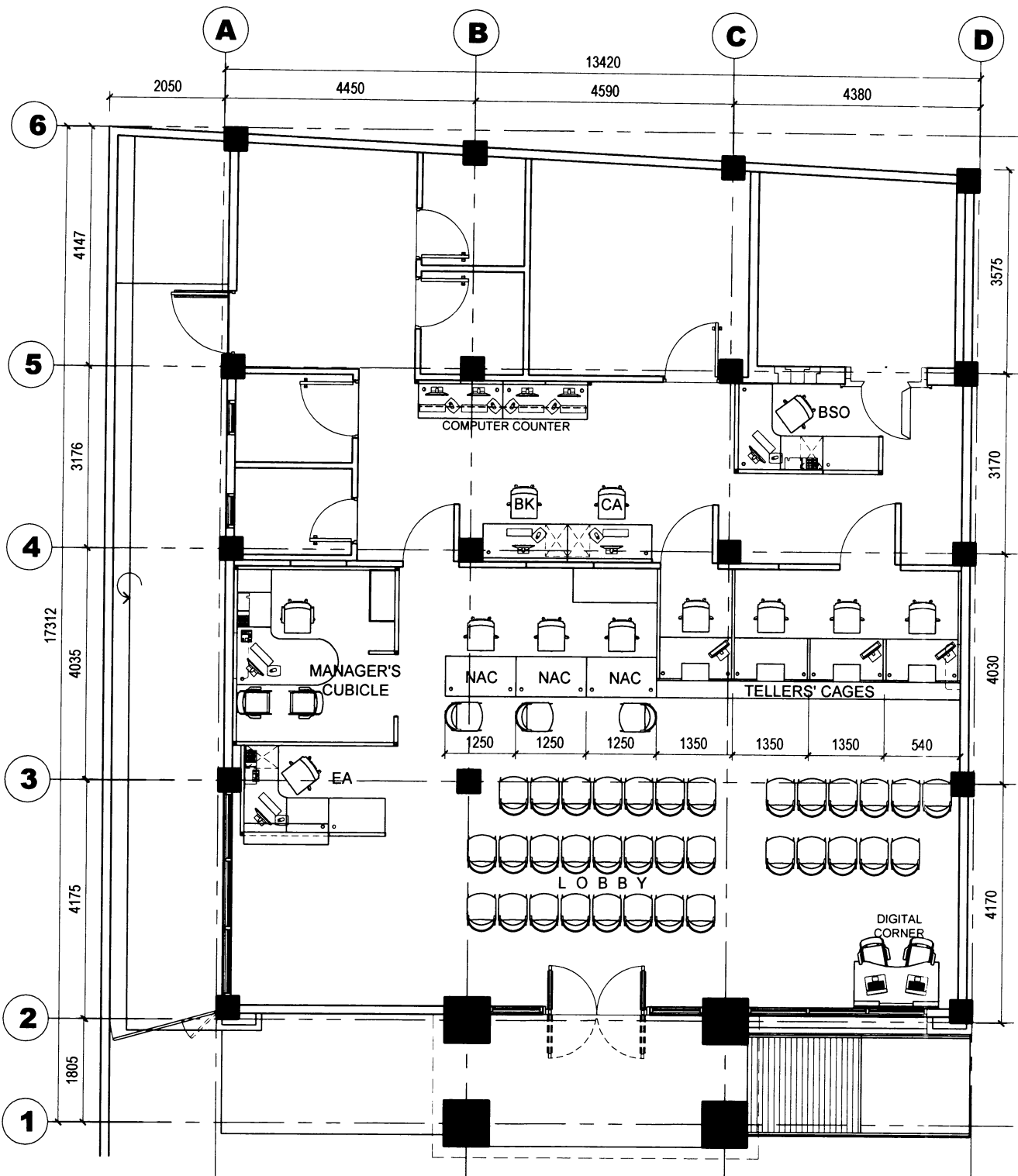

REVISION DATE:



PROJECT TITLE:

**PROPOSED LANDBANK PUERTO (CDO)  
BRANCH RENOVATION**

LOCATION: ZONE 6, BARANGAY PUERTO, CAGAYAN DE ORO

SHEET CONTENTS:

KEY PLAN

DESIGN :

PMED

SHEET NO:

DRAWN :

MARC

DATE :

11 AUGUST 2021

CHECKED :

M. PADUA

DATE :

OFMs  
1

D-67

**NOTES:**

- WRITTEN DIMENSIONS ON THESE DRAWINGS SHALL HAVE PRECEDENCE OVER SCALED DIMENSIONS.
- CONTRACTORS SHALL VERIFY AND BE RESPONSIBLE FOR ALL DIMENSIONS AND CONDITIONS ON THE JOB.
- DISCREPANCIES BETWEEN DRAWINGS AND ACTUAL CONDITION MUST BE IMMEDIATELY FORWARDED TO PMED FOR RESOLUTION.

CLASS D



BSO



1  
OFMs-3

**1:40**

## METERS

REVISIONDATE:



LOCATION: ZONE 6, BARANGAY PUERTO, CAGAYAN DE ORO

SYSTEMS FURNITURE

PMED

**SHEET NO:**

MARC

ST 2021

PADUA

---



D-68

**NOTES:**

- WRITTEN DIMENSIONS ON THESE DRAWINGS SHALL HAVE PRECEDENCE OVER SCALED DIMENSIONS.
- CONTRACTORS SHALL VERIFY AND BE RESPONSIBLE FOR ALL DIMENSIONS AND CONDITIONS ON THE JOB.
- DISCREPANCIES BETWEEN DRAWINGS AND ACTUAL CONDITION MUST BE IMMEDIATELY FORWARDED TO PMED FOR RESOLUTION.

CLASS D

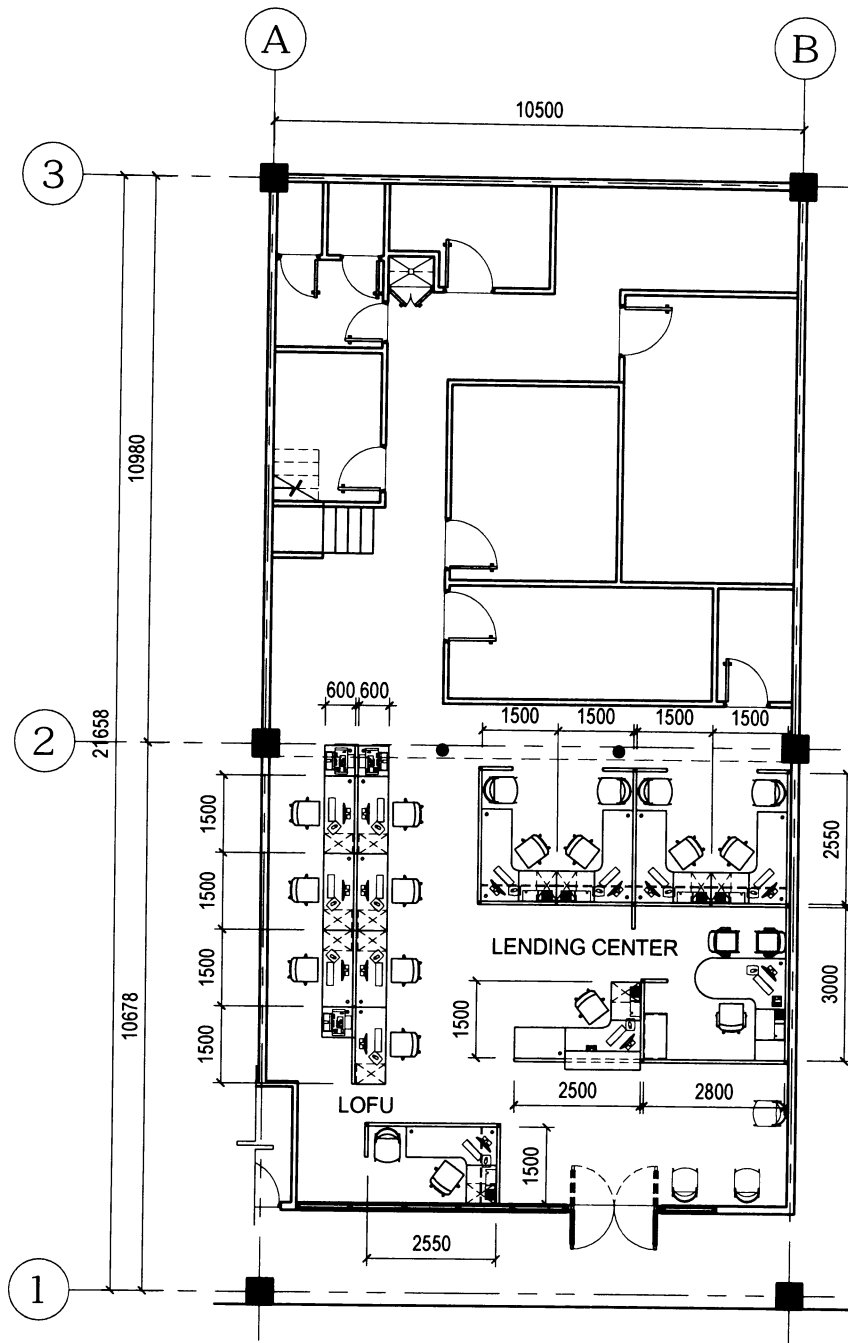

AT GROUND FLOOR  
**OF & SF KEY PLAN**  
 1  
 A-1 SCALE 1:150 METERS

REVISIONDATE:



PROJECT TITLE:

**PROPOSED LANDBANK ILOCOS NORTE  
 LENDING CENTER (FIT-OUT)**

LOCATION: VENVI IT PARK, VALDEZ CENTER, SAN NICOLAS, ILOCOS NORTE

NOTED BY:

DATE:

**JOHN ALBEN V. MISLANG**  
 HEAD, TSU - PMED

DESIGN : JAYSON-PMED

SHEET NO:

DRAWN : ANNA

DATE : 22 FEB 2021

CHECKED :

DATE :

**A**  
**1**

D-69

**NOTES:**

- WRITTEN DIMENSIONS ON THESE DRAWINGS SHALL HAVE PRECEDENCE OVER SCALED DIMENSIONS.
- CONTRACTORS SHALL VERIFY AND BE RESPONSIBLE FOR ALL DIMENSIONS AND CONDITIONS ON THE JOB.
- DISCREPANCIES BETWEEN DRAWINGS AND ACTUAL CONDITION MUST BE IMMEDIATELY FORWARDED TO PMED FOR RESOLUTION.

**CLASS D**

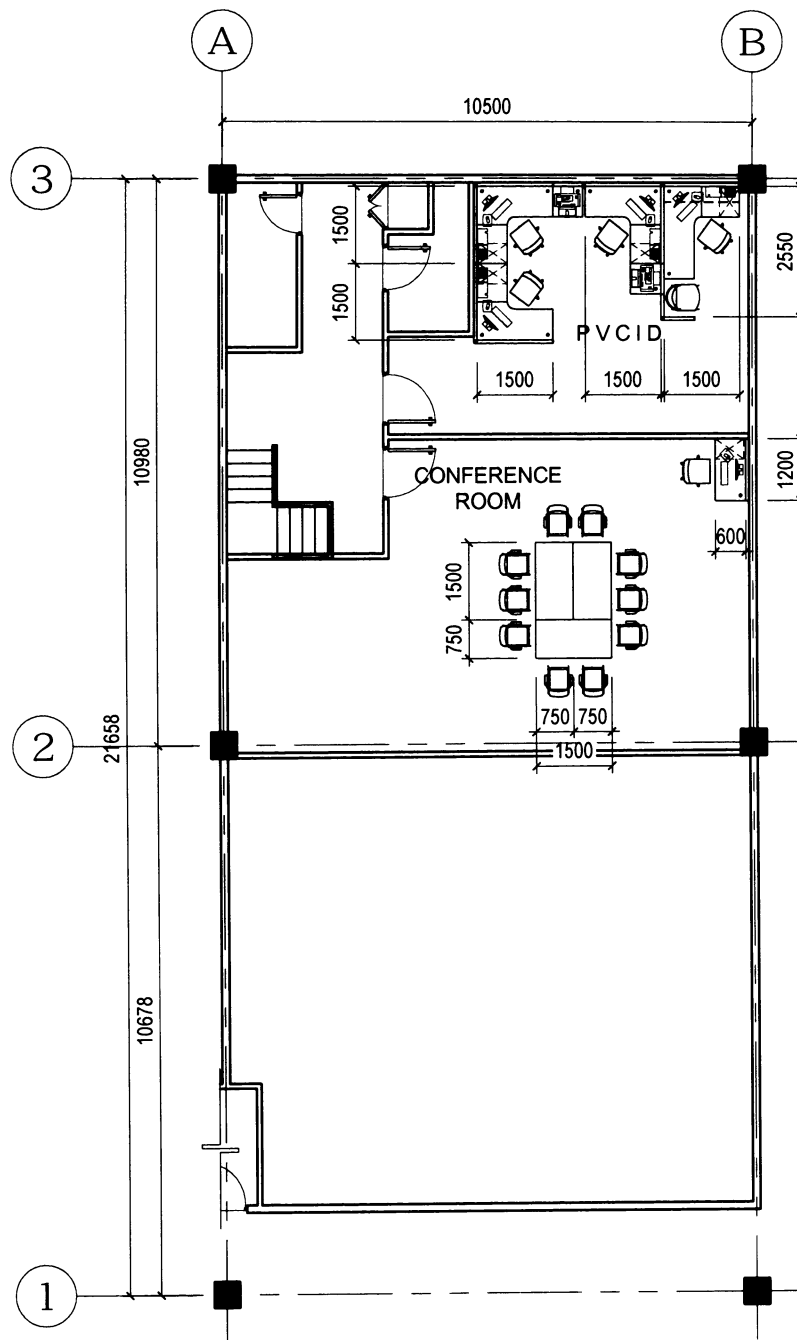

**AT MEZZANINE  
OF & SF KEY PLAN**  
1  
A-2 SCALE 1:150 METERS

REVISION DATE:



PROJECT TITLE:

**PROPOSED LANDBANK ILOCOS NORTE  
LENDING CENTER (FIT-OUT)**

LOCATION: VENVI IT PARK, VALDEZ CENTER, SAN NICOLAS, ILOCOS NORTE

NOTED BY:

DATE:

**JOHN ALBEN V. MISLANG**  
HEAD, TSU - PMED

DESIGN: JAYSON-PMED

SHEET NO:

DRAWN: ANNA

DATE: 22 FEB 2021

CHECKED:

DATE:

**A  
2**

0-70



- WRITTEN DIMENSIONS IN THESE DRAWINGS SHALL HAVE PRECEDENCE OVER SCALED DIMENSIONS.
- CONTRACTORS SHALL VERIFY AND BE RESPONSIBLE FOR ALL DIMENSIONS AND CONDITIONS ON THE JOB.
- DISCREPANCIES BETWEEN DRAWINGS AND ACTUAL CONDITION MUST BE IMMEDIATELY FORWARDED TO PMED FOR RESOLUTION.

Technical drawing of a rectangular table with dimensions 2250 (width) and 1500 (depth). The table is divided into four equal rectangular sections by a horizontal line and a vertical line. The layout shows 12 chairs around the table: 3 chairs along each of the long sides (top and bottom) and 2 chairs along each of the short sides (left and right). The chairs are represented by simple line drawings showing the back and side profiles.

**1 OFFICE FURNITURE**  
A-2 SCALE 1:50 METERS

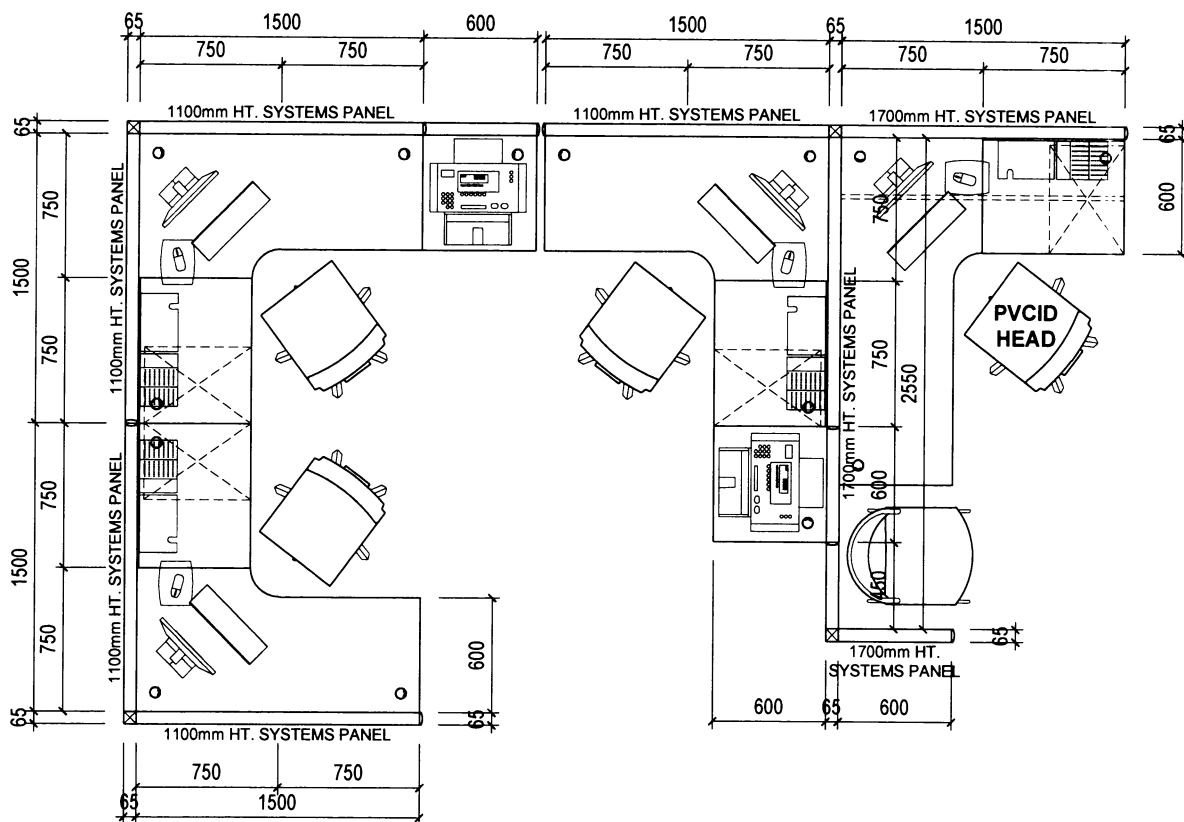

**2 SYSTEMS FURNITURE**

A-3 SCALE 1:40 METERS

	PROJECT TITLE:	NOTED BY:	DATE:	DESIGN : JAYSON-PMED	SHEET NO:
	<b>PROPOSED LANDBANK ILOCOS NORTE LENDING CENTER (FIT-OUT)</b>	<b><u>JOHN ALBEN V. MISLANG</u></b> HEAD, TSU - PMED		DRAWN : ANNA	<div style="border: 2px solid black; border-radius: 50%; width: 60px; height: 60px; display: flex; align-items: center; justify-content: center; margin: 0 auto;"> <div style="font-size: 24px; font-weight: bold; text-align: center;">A</div> <div style="font-size: 24px; font-weight: bold; text-align: center;">2</div> </div>
				DATE : 22 FEB 2021	
				CHECKED :	
				DATE :	
LOCATION: VENVI IT PARK, VALDEZ CENTER, SAN NICOLAS, ILOCOS NORTE					

D-71

**NOTES:**

- WRITTEN DIMENSIONS ON THESE DRAWINGS SHALL HAVE PRECEDENCE OVER SCALED DIMENSIONS.
- CONTRACTORS SHALL VERIFY AND BE RESPONSIBLE FOR ALL DIMENSIONS AND CONDITIONS ON THE JOB.
- DISCREPANCIES BETWEEN DRAWINGS AND ACTUAL CONDITION MUST BE IMMEDIATELY FORWARDED TO PMED FOR RESOLUTION.

**CLASS D**

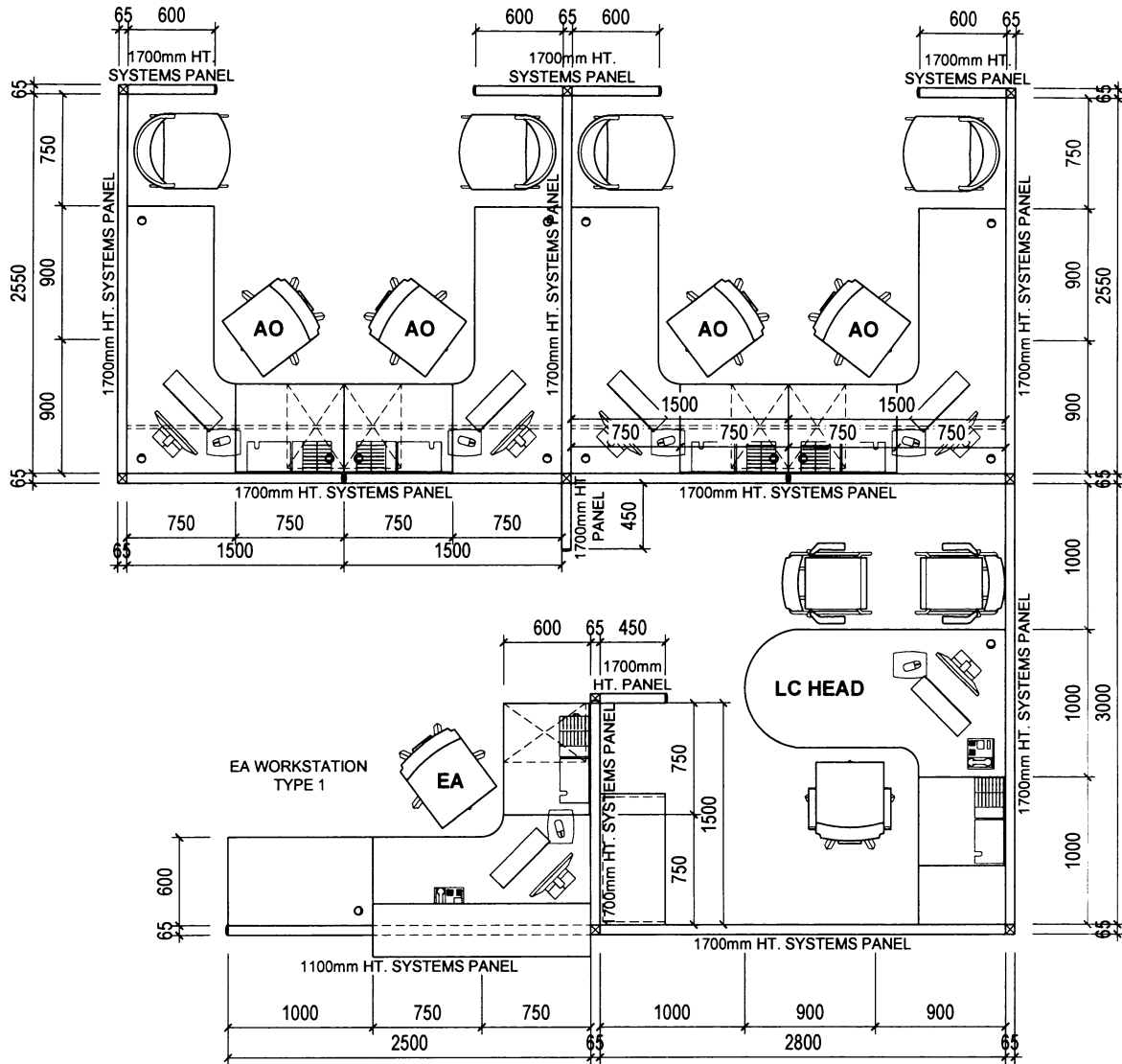

**LENDING CENTER**

**1** **SYSTEMS FURNITURE**  
A-4 SCALE 1:50 METERS

REVISION DATE:

	PROJECT TITLE:	NOTED BY:	DATE:	DESIGN : JAYSON-PMED	SHEET NO:
	PROPOSED LANDBANK ILOCOS NORTE LENDING CENTER (FIT-OUT)	<b>JOHN ALBEN V. MISLANG</b> HEAD, TSU - PMED		DRAWN : ANNA	<b>A</b> <b>4</b>
	LOCATION: VENVI IT PARK, VALDEZ CENTER, SAN NICOLAS, ILOCOS NORTE			DATE : 22 FEB 2021	
				CHECKED :	
				DATE :	

D-72

**NOTES:**

- WRITTEN DIMENSIONS ON THESE DRAWINGS SHALL HAVE PRECEDENCE OVER SCALED DIMENSIONS.
- CONTRACTORS SHALL VERIFY AND BE RESPONSIBLE FOR ALL DIMENSIONS AND CONDITIONS ON THE JOB.
- DISCREPANCIES BETWEEN DRAWINGS AND ACTUAL CONDITION MUST BE IMMEDIATELY FORWARDED TO PMED FOR RESOLUTION.

**CLASS D**

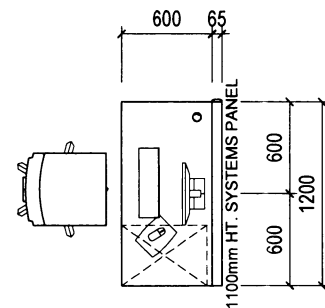
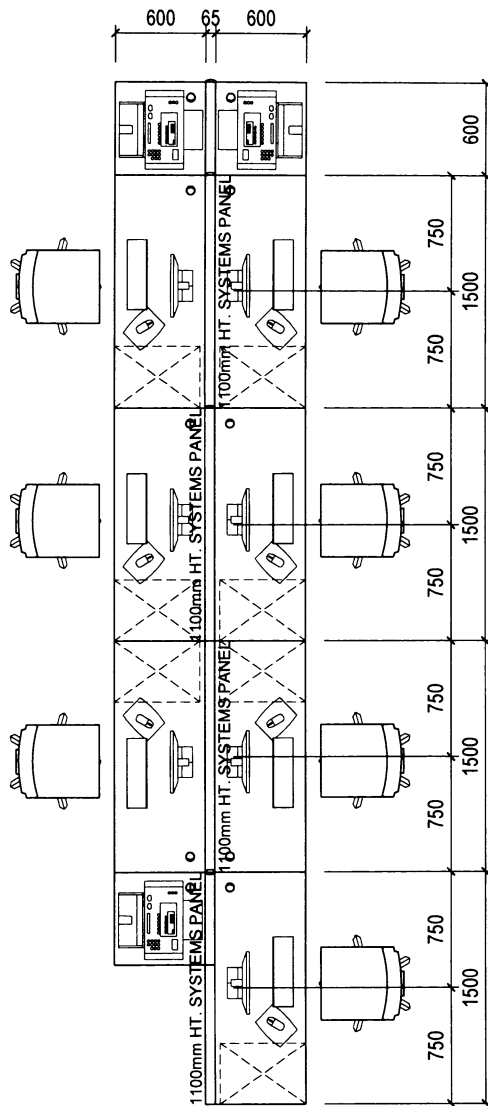

**CONFERENCE ROOM**

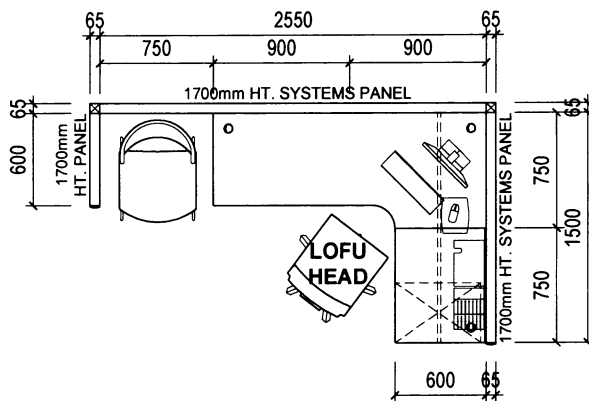

**LOFU**

**1 SYSTEMS FURNITURE**  
A-5 SCALE 1:50 METERS

REVISION DATE:

	PROJECT TITLE:	NOTED BY:	DATE:	DESIGN : JAYSON-PMED	SHEET NO:
	PROPOSED LANDBANK ILOCOS NORTE LENDING CENTER (FIT-OUT)	JOHN ALBEN V. MISLANG HEAD, TSU - PMED		DRAWN : ANNA	<div style="border: 1px solid black; border-radius: 50%; width: 40px; height: 40px; display: flex; align-items: center; justify-content: center; margin: 0 auto;"> <div style="text-align: center;">A 5</div> </div>
	LOCATION: VENVI IT PARK, VALDEZ CENTER, SAN NICOLAS, ILOCOS NORTE			DATE : 22 FEB 2021	
				CHECKED :	
				DATE :	

D-73



**TITLE:**

**PROPOSED LANDBANK SORSOGON BRANCH  
RENOVATION**

**LOCATION: BONACUA BLDG., RIZAL COR. BURGOS STS. SORSOGON CITY SORSOGON**

CONFORME:	DATE:
<p><b>JOHN ALBEN V. MISLANG</b> BUILDING ADMIN</p>	

SHEET CONTENT:	
	<p style="text-align: center;">KEY PLAN OFFICE FURNITURE BLOW-UP</p>

DESIGN:	PMED
DRAWN:	ROLAND
DATE:	31 AUGUST 2021
CHECKED:	MARC
DATE:	



D-74

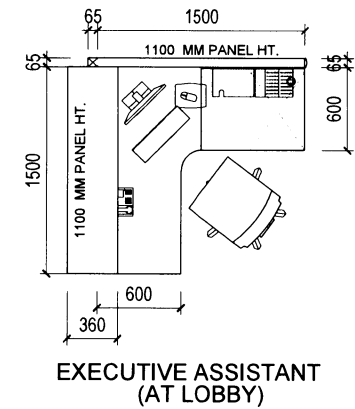
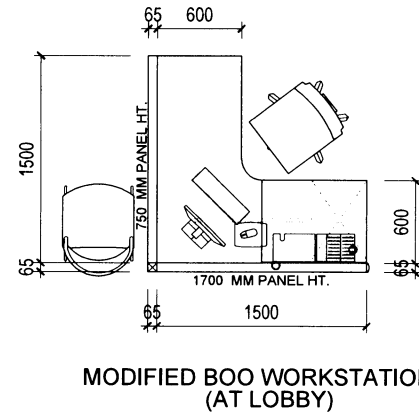
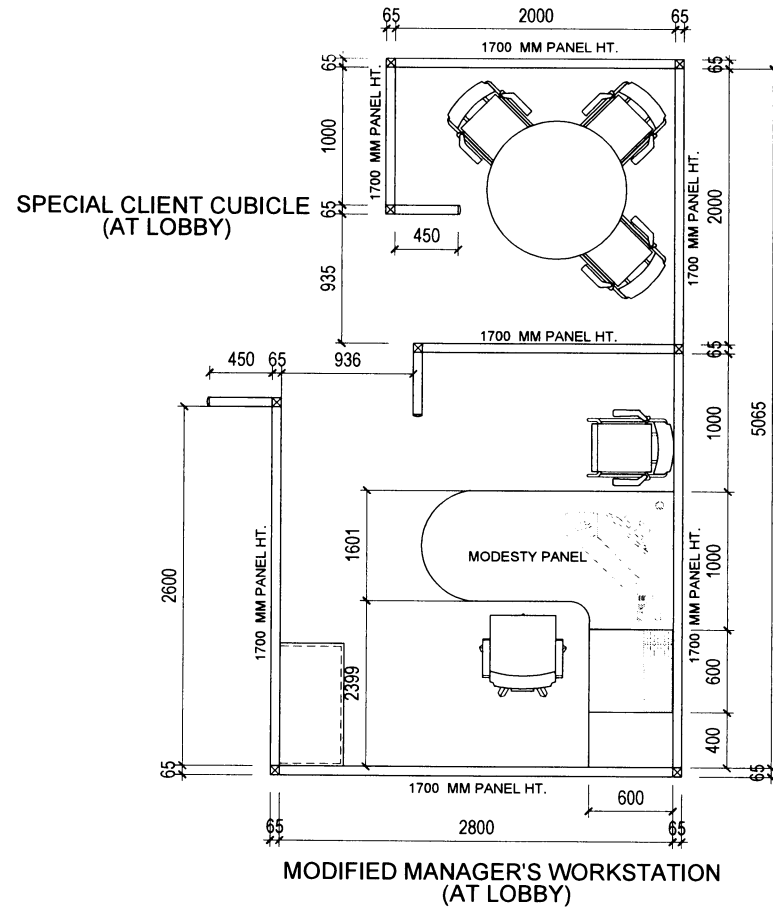

**1** **SYSTEMS FURNITURE BLOW-UP**  
A-2 SCALE 1:50 METERS



**LANDBANK OF THE PHILIPPINES**  
PROJECT MANAGEMENT & ENGINEERING DEPT.  
1598 M.H. DEL PILAR ST., CORNER DR. QUINTOS ST., MALATE, MANILA

TITLE:  
**PROPOSED LANDBANK SORSOGON BRANCH RENOVATION**

LOCATION: BONACUA BLDG., RIZAL COR. BURGOS STs, SORSOGON CITY SORSOGON

CONFORME:

DATE:

SHEET CONTENT:

DESIGN:

PMED

SHEET NO:

**JOHN ALBEN V. MISLANG**  
BUILDING ADMIN

SYSTEMS FURNITURE BLOW-UP

DRAWN:

ROLAND

DATE:

31 AUGUST 2021

CHECKED:

MARC

DATE:

**OFM**  
**2**

56-D

**NOTES:**

- WRITTEN DIMENSIONS ON THESE DRAWINGS SHALL HAVE PRECEDENCE OVER SCALED DIMENSIONS
- CONTRACTORS SHALL VERIFY AND BE RESPONSIBLE FOR ALL DIMENSIONS AND CONDITIONS ON THE JOB
- DISCREPANCIES BETWEEN DRAWINGS AND ACTUAL CONDITION MUST BE IMMEDIATELY FORWARDED TO PMED FOR RESOLUTION.

**CLASS D**

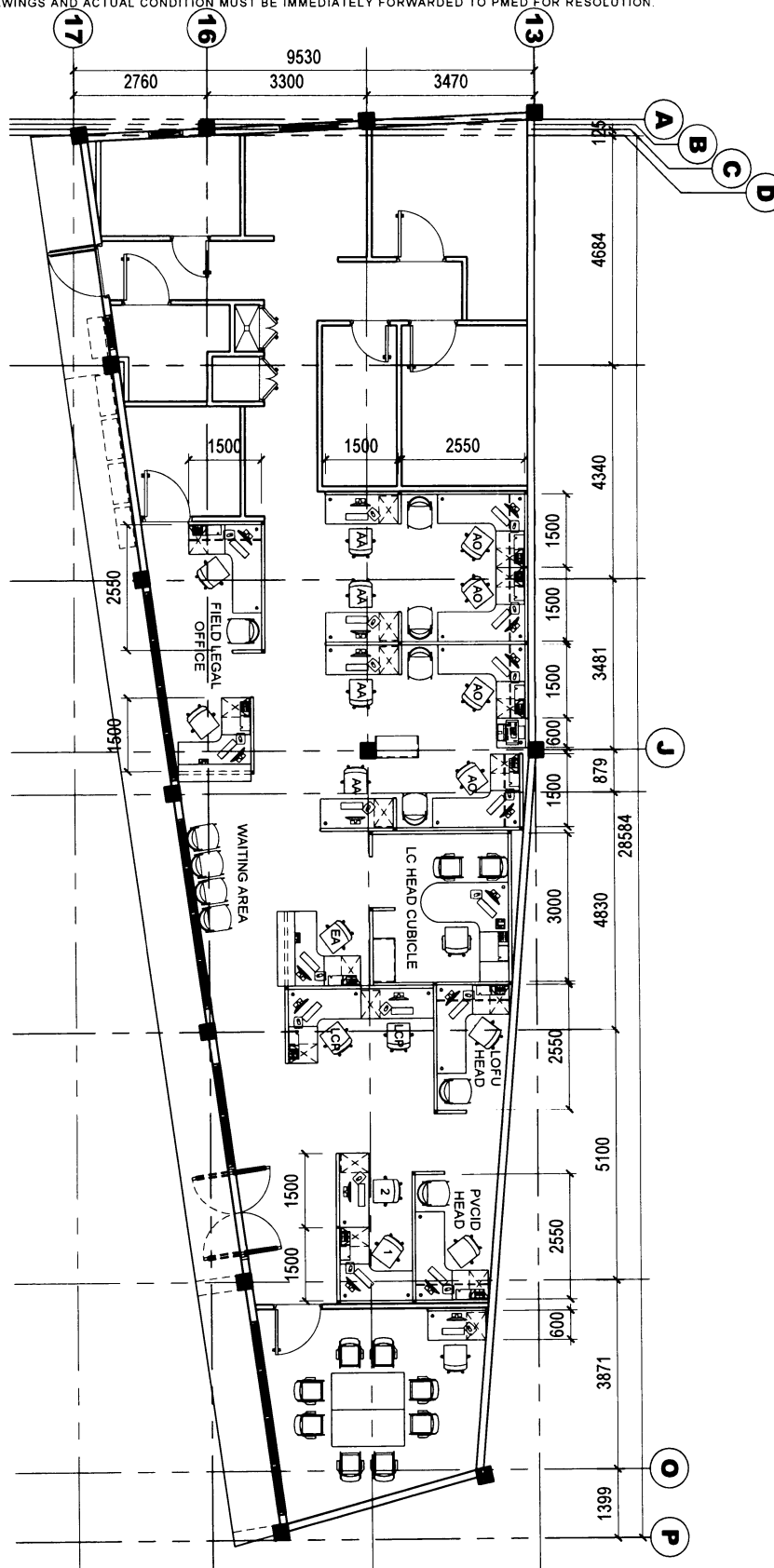

**1 OF & SF KEY PLAN**  
A-1 SCALE 1:140 METERS

REVISION/DATE:



PROJECT TITLE:

**PROPOSED LANDBANK SORSOGON  
LENDING CENTER**

LOCATION: BURGOS STREET, SORSOGON CITY

NOTED BY:

DATE:

**ENRICO D.J. SAMANIEGO**  
HEAD, PMED

DESIGN : TSU-PMED

DRAWN : ANNA S.

DATE : 01 SEPT 2021

CHECKED :

DATE :

SHEET NO:

**A  
1**

D-76

# NOTES:

- WRITTEN DIMENSIONS ON THESE DRAWINGS SHALL HAVE PRECEDENCE OVER SCALED DIMENSIONS.
- CONTRACTORS SHALL VERIFY AND BE RESPONSIBLE FOR ALL DIMENSIONS AND CONDITIONS ON THE JOB.
- DISCREPANCIES BETWEEN DRAWINGS AND ACTUAL CONDITION MUST BE IMMEDIATELY FORWARDED TO PMED FOR RESOLUTION.

CLASS D

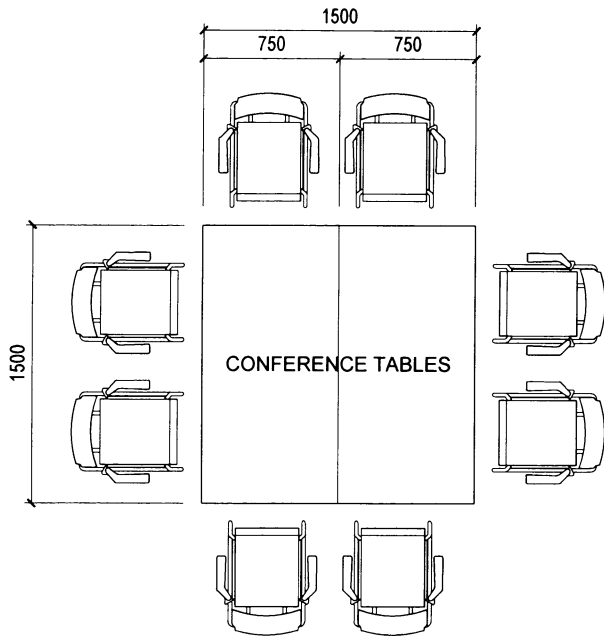

**CONFERENCE ROOM**

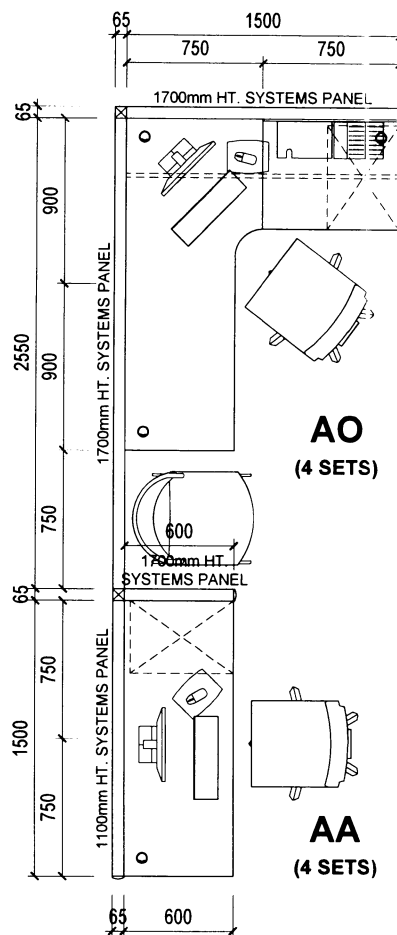

**1 OFFICE FURNITURE**  
A-2 SCALE 1:40 METERS

**2 SYSTEMS FURNITURE - A**  
A-2 SCALE 1:40 METERS

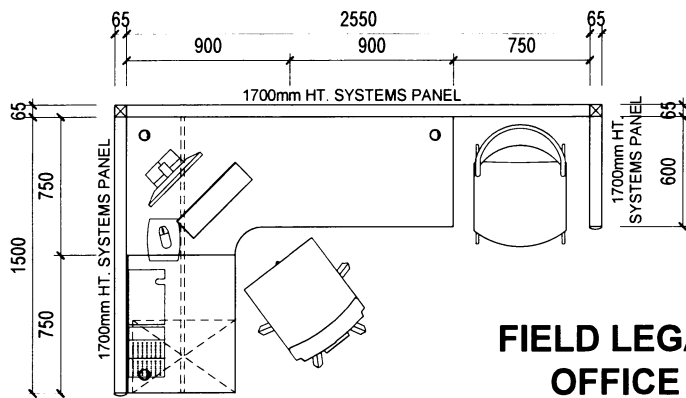

**FIELD LEGAL OFFICE**

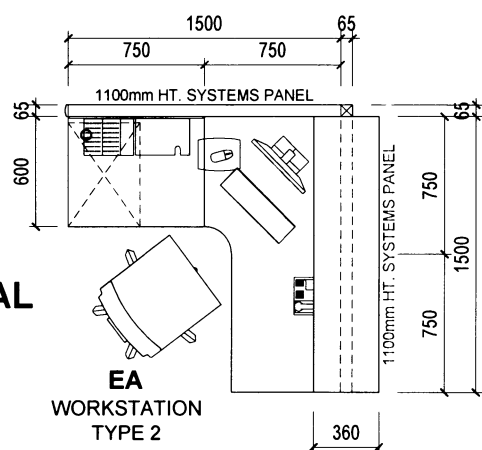

**EA WORKSTATION TYPE 2**

**3 SYSTEMS FURNITURE - B**  
A-2 SCALE 1:40 METERS

REVISION DATE:



PROJECT TITLE:

**PROPOSED LANDBANK SORSOGON LENDING CENTER**

LOCATION: BURGOS STREET, SORSOGON CITY

NOTED BY:

DATE:

**ENRICO DJ. SAMANIEGO**  
HEAD, PMED

DESIGN : TSU-PMED

DRAWN : ANNA S.

DATE : 01 SEPT 2021

CHECKED :

DATE :

SHEET NO:

**A 2**

**NOTES:**

- WRITTEN DIMENSIONS ON THESE DRAWINGS SHALL HAVE PRECEDENCE OVER SCALED DIMENSIONS.
- CONTRACTORS SHALL VERIFY AND BE RESPONSIBLE FOR ALL DIMENSIONS AND CONDITIONS ON THE JOB.
- DISCREPANCIES BETWEEN DRAWINGS AND ACTUAL CONDITION MUST BE IMMEDIATELY FORWARDED TO PMED FOR RESOLUTION.

**CLASS D**

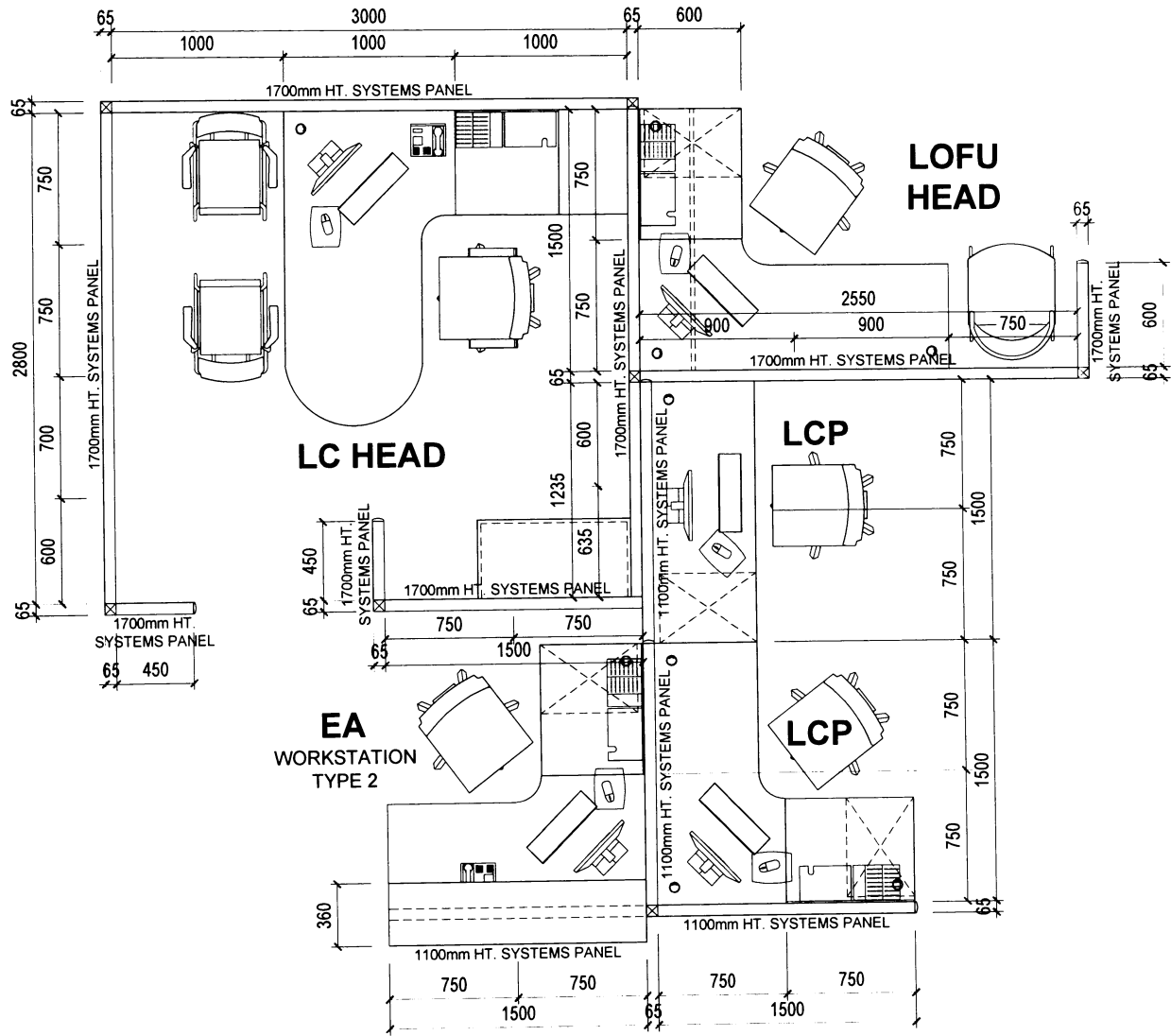

**LENDING CENTER**

**LOFU**

**1** **SYSTEMS FURNITURE - C**  
**A-3** SCALE 1:40 METERS

REVISION DATE:



PROJECT TITLE:

**PROPOSED LANDBANK SORSOGON  
LENDING CENTER**

LOCATION: BURGOS STREET, SORSOGON CITY

NOTED BY:

DATE:

**ENRICO DJ. SAMANIEGO**  
HEAD, PMED

DESIGN : TSU-PMED

SHEET NO:

DRAWN : ANNA S.

DATE : 01 SEPT 2021

CHECKED :

DATE :

**A**  
**3**

D-78



- WRITTEN DIMENSIONS ON THESE DRAWINGS SHALL HAVE PRECEDENCE OVER SCALED DIMENSIONS.
- CONTRACTORS SHALL VERIFY AND BE RESPONSIBLE FOR ALL DIMENSIONS AND CONDITIONS ON THE JOB
- DISCREPANCIES BETWEEN DRAWINGS AND ACTUAL CONDITION MUST BE IMMEDIATELY FORWARDED TO PMED FOR RESOLUTION

Technical drawing of a PVCID HEAD layout, showing dimensions and components. The layout is divided into two main sections: a top section labeled "PVCID HEAD" and a bottom section labeled "1100mm HT. SYSTEMS PANEL".

**Top Section (PVCID HEAD):**

- Overall width: 600mm (main section) + 65mm (side panel).
- Overall height: 1500mm (main section) + 65mm (top panel).
- Components include a "PVCID HEAD" unit, a "1700mm HT. SYSTEMS PANEL" unit, and a "1100mm HT. SYSTEMS PANEL" unit.
- Dimensions for the top section: 600mm, 65mm, 1700mm HT. SYSTEMS PANEL, 1700mm HT. SYSTEMS PANEL, 1500mm, 750mm, 900mm, 900mm, 65mm.

**Bottom Section (1100mm HT. SYSTEMS PANEL):**

- Overall width: 1500mm (main section) + 65mm (side panel).
- Overall height: 1100mm (main section) + 65mm (bottom panel).
- Components include a "1100mm HT. SYSTEMS PANEL" unit, a "1100mm HT. SYSTEMS PANEL" unit, and a "1100mm HT. SYSTEMS PANEL" unit.
- Dimensions for the bottom section: 1100mm HT. SYSTEMS PANEL, 1100mm HT. SYSTEMS PANEL, 1100mm HT. SYSTEMS PANEL, 1500mm, 750mm, 750mm, 750mm, 750mm, 65mm.

**Central Section:**

- Overall width: 2550mm.
- Overall height: 1500mm.
- Components include a "2" unit, a "1" unit, and a "1100mm HT. SYSTEMS PANEL" unit.
- Dimensions for the central section: 2550mm, 1500mm, 750mm, 900mm, 900mm, 65mm.

Technical drawing of the HT-Systems Panel. The panel is 1200mm high and 600mm wide. It features a 65mm wide top section and a 600mm wide bottom section. The panel is labeled "1100mm HT. SYSTEMS PANEL". A circular component is shown on the left side, and a rectangular component is shown on the right side. A dashed line indicates a diagonal cut or internal structure.

**1** **SYSTEMS FURNITURE - D**  
**A-4** **SCALE** **1:40** **METERS**

**PROPOSED LANDBANK SORSOGON  
LENDING CENTER**

**ENRICO DJ. SAMANIEGO**  
HEAD, PMED



D-79

**NOTES:**

- WRITTEN DIMENSIONS ON THESE DRAWINGS SHALL HAVE PRECEDENCE OVER SCALED DIMENSIONS
- CONTRACTORS SHALL VERIFY AND BE RESPONSIBLE FOR ALL DIMENSIONS AND CONDITIONS ON THE JOB.
- DISCREPANCIES BETWEEN DRAWINGS AND ACTUAL CONDITION MUST BE IMMEDIATELY FORWARDED TO PMEN FOR RESOLUTION.

**CLASS D**

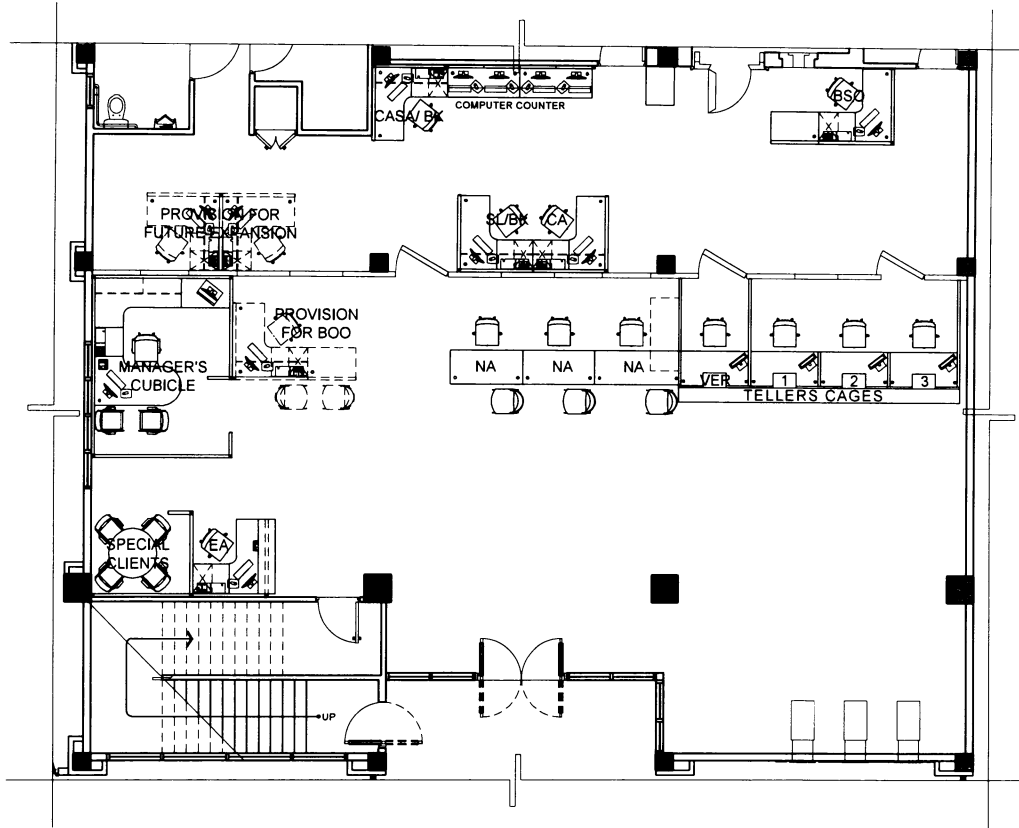

**1 GROUND FLOOR KEY PLAN**  
**SF-1** SCALE 1:150 METERS

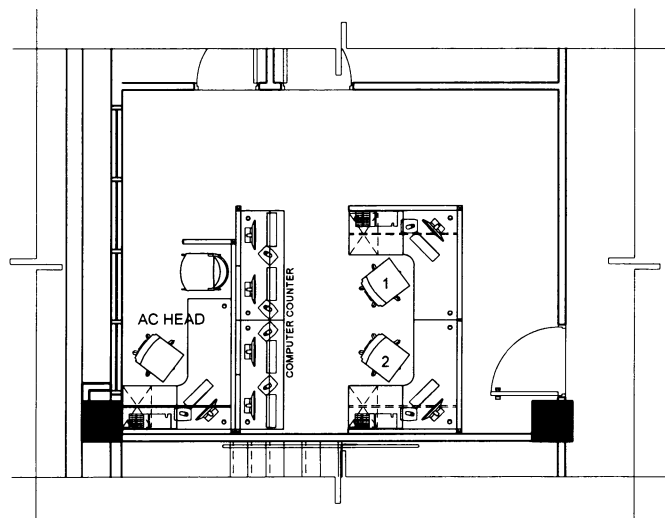

**2 SECOND FLOOR KEY PLAN**  
**SF-1** SCALE 1:100 METERS

REVISION DATE:



**PROJECT TITLE:**  
**PROPOSED LANDBANK ODIONGAN  
 BRANCH RELOCATION/ BLDG.  
 CONSTRUCTION--SYSTEMS FURNITURE**

**LOCATION:** NATIONAL ROAD, BRGY. DAPAWAN, ODIONGAN, ROMBLON

**NOTED BY:**

**DATE:**

**DESIGN :**

**PMED**

**SHEET NO:**

**DRAWN :**

**MAUI-TSU**

**DATE :**

**AUGUST 31, 2021**

**CHECKED :**

**E. LAUREL**

**DATE :**

**JOHN ALBEN V. MISLANG**  
 HEAD. TSU - PMED

**SF  
1**

D-80

NOTES:

- WRITTEN DIMENSIONS AND DIMENSION LINES SHALL HAVE PRECEDENCE OVER SCALED DIMENSIONS.
- CONTRACTOR SHALL BE RESPONSIBLE FOR ALL DIMENSIONS AND CONDITIONS ON THE JOB.
- DISCREPANCIES BETWEEN DRAWING AND ACTUAL CONDITION MUST BE IMMEDIATELY FORWARDED TO OWNER FOR RESOLUTION.

CLASS D

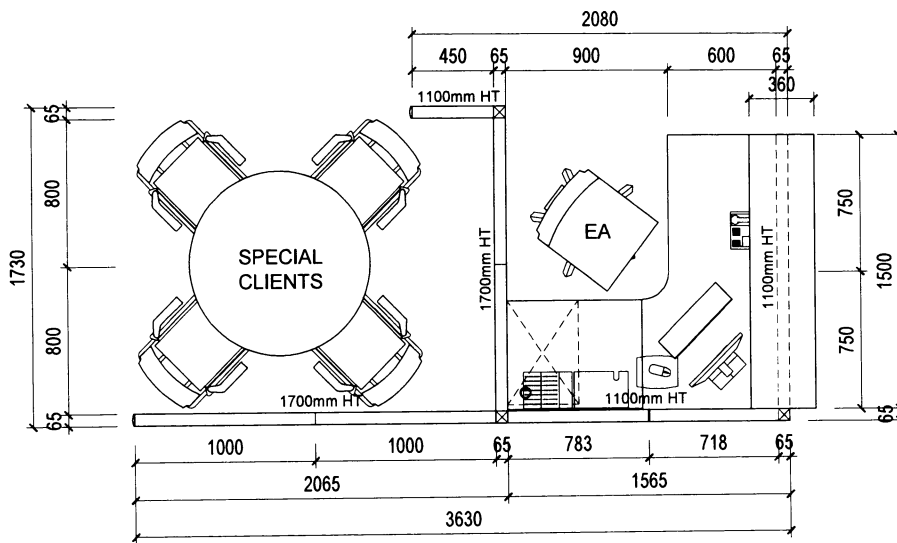

## EA AND SPECIAL CLIENTS

SCALE

1:40 M

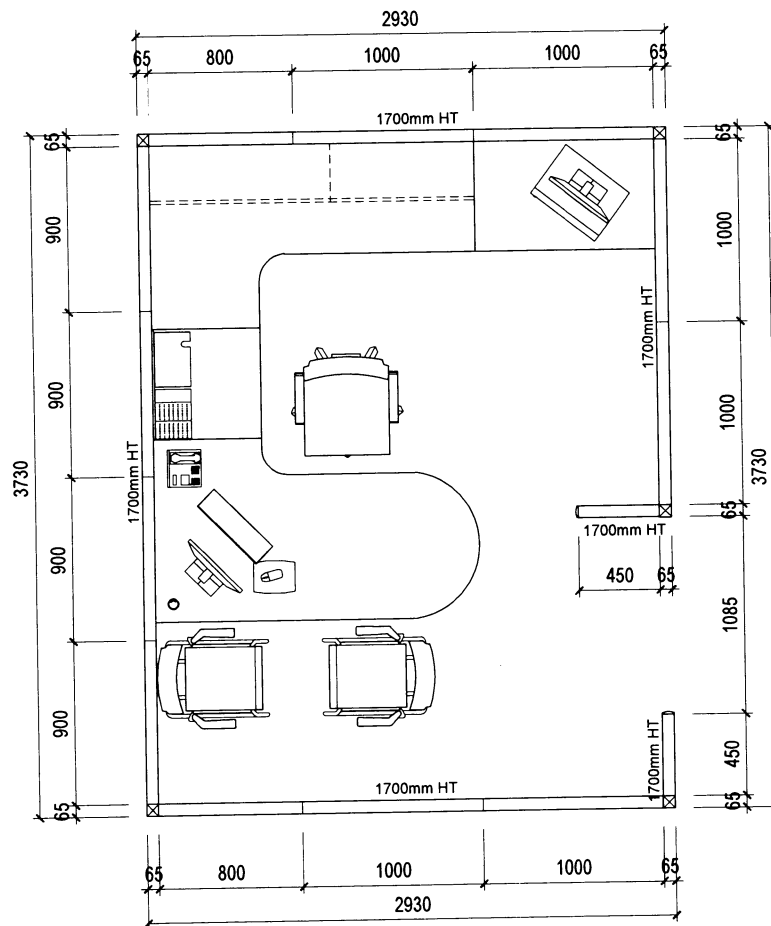

## MANAGERS CUBICLE

SCALE

1:40 M

REVISION DATE:



PROJECT TITLE:

**PROPOSED LANDBANK ODIONGAN  
BRANCH RELOCATION/ BLDG.  
CONSTRUCTION--SYSTEMS FURNITURE**

LOCATION: NATIONAL ROAD, BRGY. DAPAWAN, ODIONGAN, ROMBLON

NOTED BY:

DATE:

DESIGN :

PMED

SHEET NO:

DRAWN :

MAUI-TSU

DATE :

AUGUST 31, 2021

CHECKED :

E. LAUREL

DATE :

**JOHN ALBEN V. MISLANG**  
HEAD, TSU - PMED

**SF**  
**2**

NOTES:

- WRITTEN DIMENSIONS ON THESE DRAWINGS SHALL HAVE PRECEDENCE OVER SCALED DIMENSIONS
- CONTRACTORS SHALL VERIFY AND BE RESPONSIBLE FOR ALL DIMENSIONS AND CONDITIONS ON THE SITE.
- DISCREPANCIES BETWEEN DRAWINGS AND ACTUAL CONDITION MUST BE IMMEDIATELY FORWARDED TO PMED FOR RESOLUTION.

CLASS D

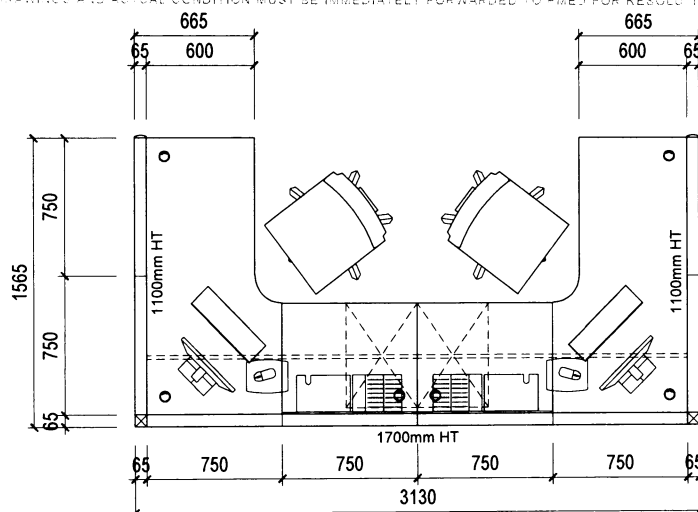

**SL/BK AND CA WORKSTATION**

SCALE

1:40 M

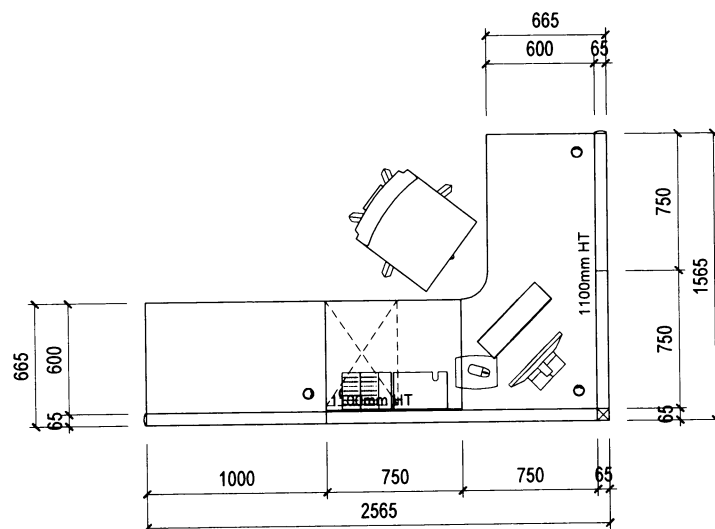

**BSO WORKSTATION**

SCALE

1:40 M

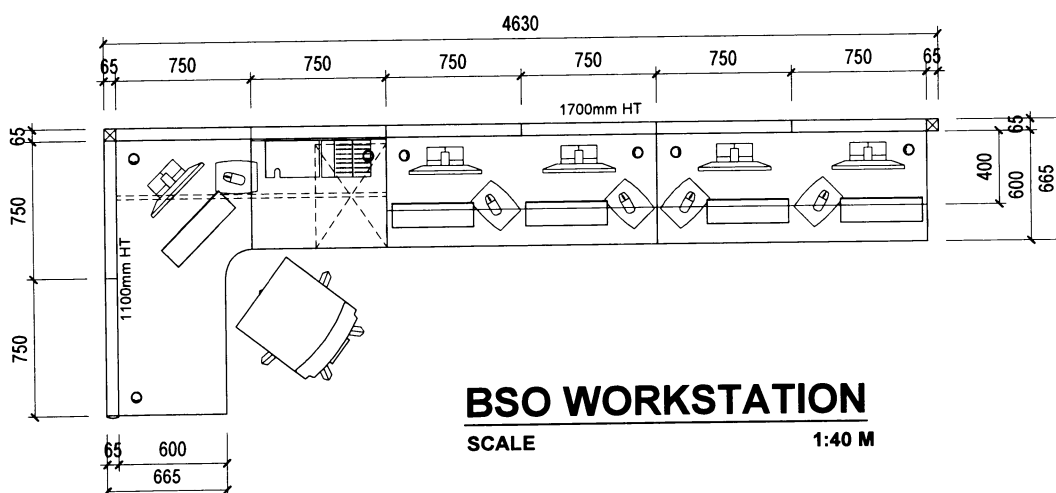

**BSO WORKSTATION**

SCALE

1:40 M

REVISION DATE:



PROJECT TITLE:

**PROPOSED LANDBANK ODIONGAN  
BRANCH RELOCATION/ BLDG.  
CONSTRUCTION--SYSTEMS FURNITURE**

LOCATION: NATIONAL ROAD, BRGY. DAPAWAN, ODIONGAN, ROMBLON

NOTED BY:

DATE:

DESIGN :

PMED

SHEET NO:

DRAWN :

MAUI-TSU

DATE :

AUGUST 31, 2021

CHECKED :

E. LAUREL

DATE :

**JOHN ALBEN V. MISLANG**  
HEAD, TSU - PMED

**SF**  
**4**

D-82

# NOTES:

- WRITTEN DIMENSIONS ON THESE DRAWINGS SHALL HAVE PRECEDENCE OVER SCALED DIMENSIONS.
- CONTRACTORS SHALL VERIFY AND BE RESPONSIBLE FOR ALL DIMENSIONS AND CONDITIONS ON THE JOB.
- DISCREPANCIES BETWEEN DRAWINGS AND ACTUAL CONDITION MUST BE IMMEDIATELY FORWARDED TO PMED FOR RESOLUTION.

CLASS D

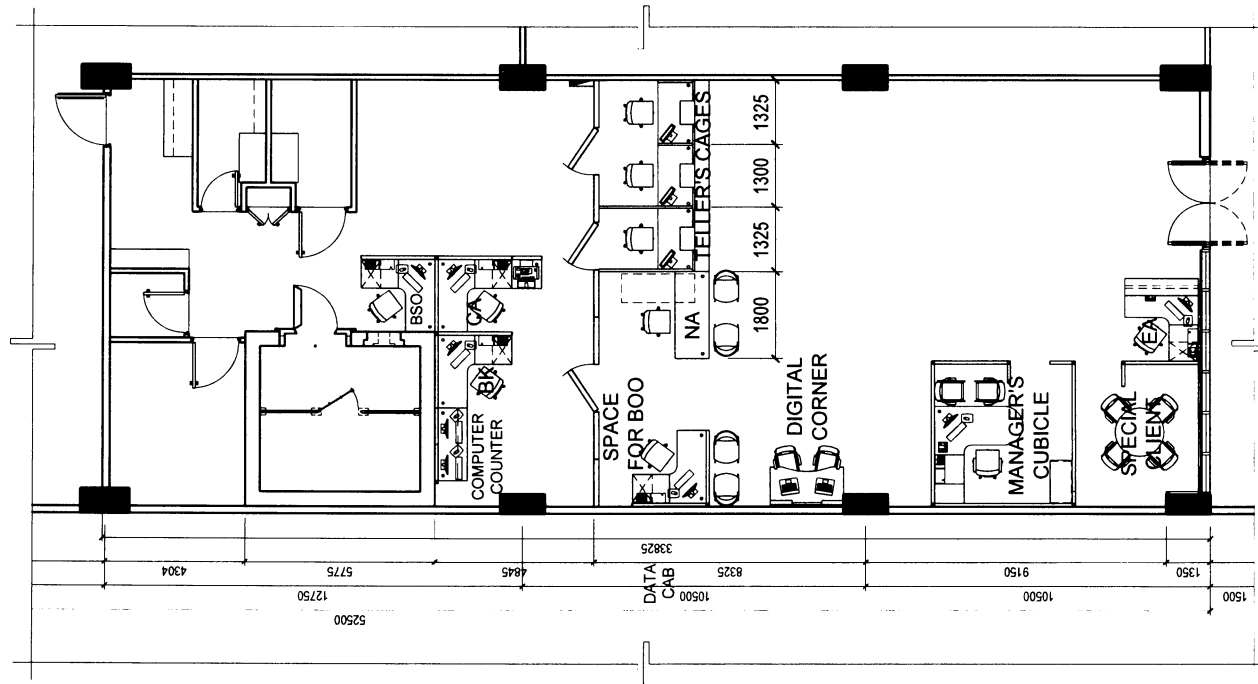

**1** **KEY PLAN**  
SF-1 SCALE 1:150 METERS

REVISION DATE:



**LANDBANK OF THE PHILIPPINES**

PROJECT MANAGEMENT & ENGINEERING DEPT.  
1598 M.H. DEL PILAR ST., CORNER DR. QUINTOS ST., MALATE,  
MANILA

PROJECT TITLE:

**PROPOSED LANDBANK G ARANETA BRANCH  
RELOCATION (FIT-OUT)**

LOCATION: CENTRAL WORLD BUILDING, 341 G. ARANETA AVE., BRGY DOÑA IMELDA, Q.C.

NOTED BY:

DATE:

SHEET CONTENT:

DESIGN : TSU-PMED

SHEET NO:

**JOHN ALBEN V. MISLANG**  
HEAD, TSU - PMED

KEYPLAN

DRAWN : EDREL

DATE : 08-27-2021

CHECKED :

DATE :



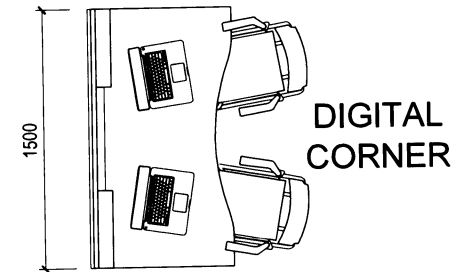
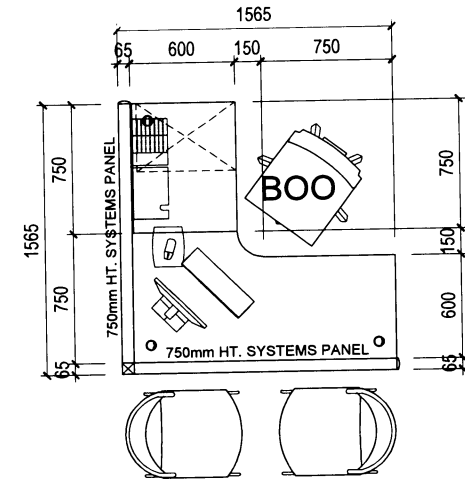
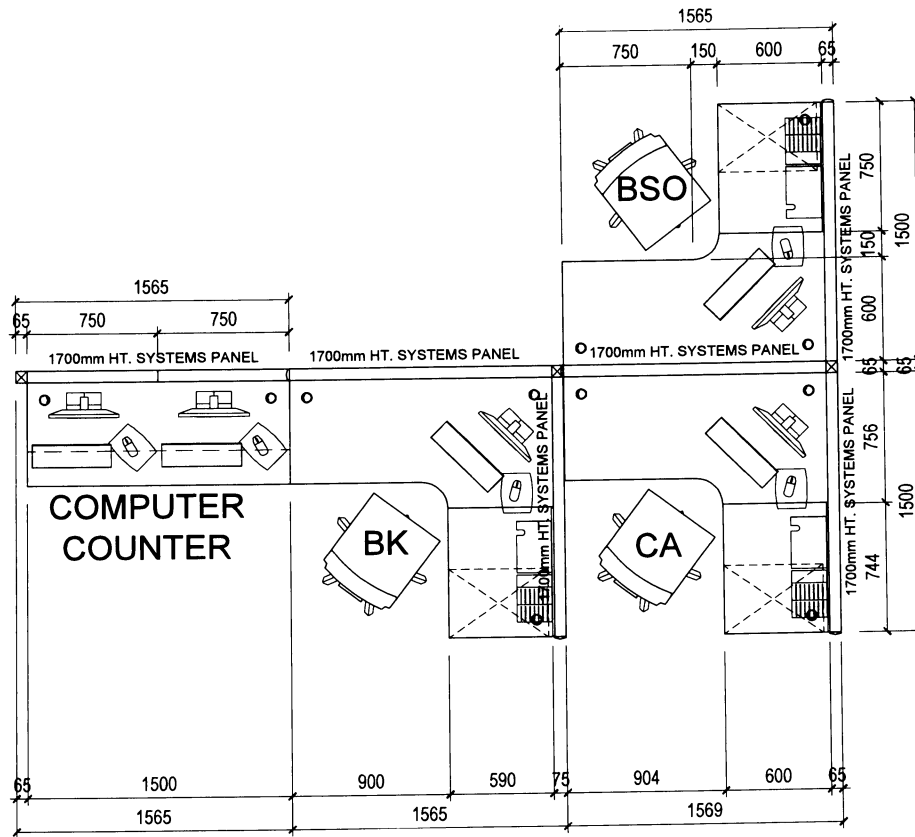

D-83

- NOTES:**
- WRITTEN DIMENSIONS ON THESE DRAWINGS SHALL HAVE PRECEDENCE OVER SCALED DIMENSIONS.
  - CONTRACTORS SHALL VERIFY AND BE RESPONSIBLE FOR ALL DIMENSIONS AND CONDITIONS ON THE JOB.
  - DISCREPANCIES BETWEEN DRAWINGS AND ACTUAL CONDITION MUST BE IMMEDIATELY FORWARDED TO PMED FOR RESOLUTION.



**1** **SYSTEMS FURNITURE - A**  
A-2 SCALE 1:40 METERS

REVISION DATE:

	<b>LANDBANK OF THE PHILIPPINES</b> PROJECT MANAGEMENT & ENGINEERING DEPT. 1598 M.H. DEL PILAR ST., CORNER DR. QUINTOS ST., MALATE, MANILA	<b>PROJECT TITLE:</b>  <b>PROPOSED LANDBANK G ARANETA BRANCH RELOCATION (FIT-OUT)</b>  <b>LOCATION:</b> CENTRAL WORLD BUILDING, 341 G. ARANETA AVE., BRGY DOÑA IMELDA, Q.C.	<b>NOTED BY:</b>  <b>JOHN ALBEN V. MISLANG</b> HEAD, TSU - PMED	<b>DATE:</b>  SYSTEMS FURNITURE A	<b>SHEET CONTENT:</b>  SYSTEMS FURNITURE A	<b>DESIGN :</b> TSU-PMED	<b>SHEET NO:</b>
						<b>DRAWN :</b> EDREL	
						<b>DATE :</b> 08-27-2021	
						<b>CHECKED :</b>	
						<b>DATE :</b>	

D-84

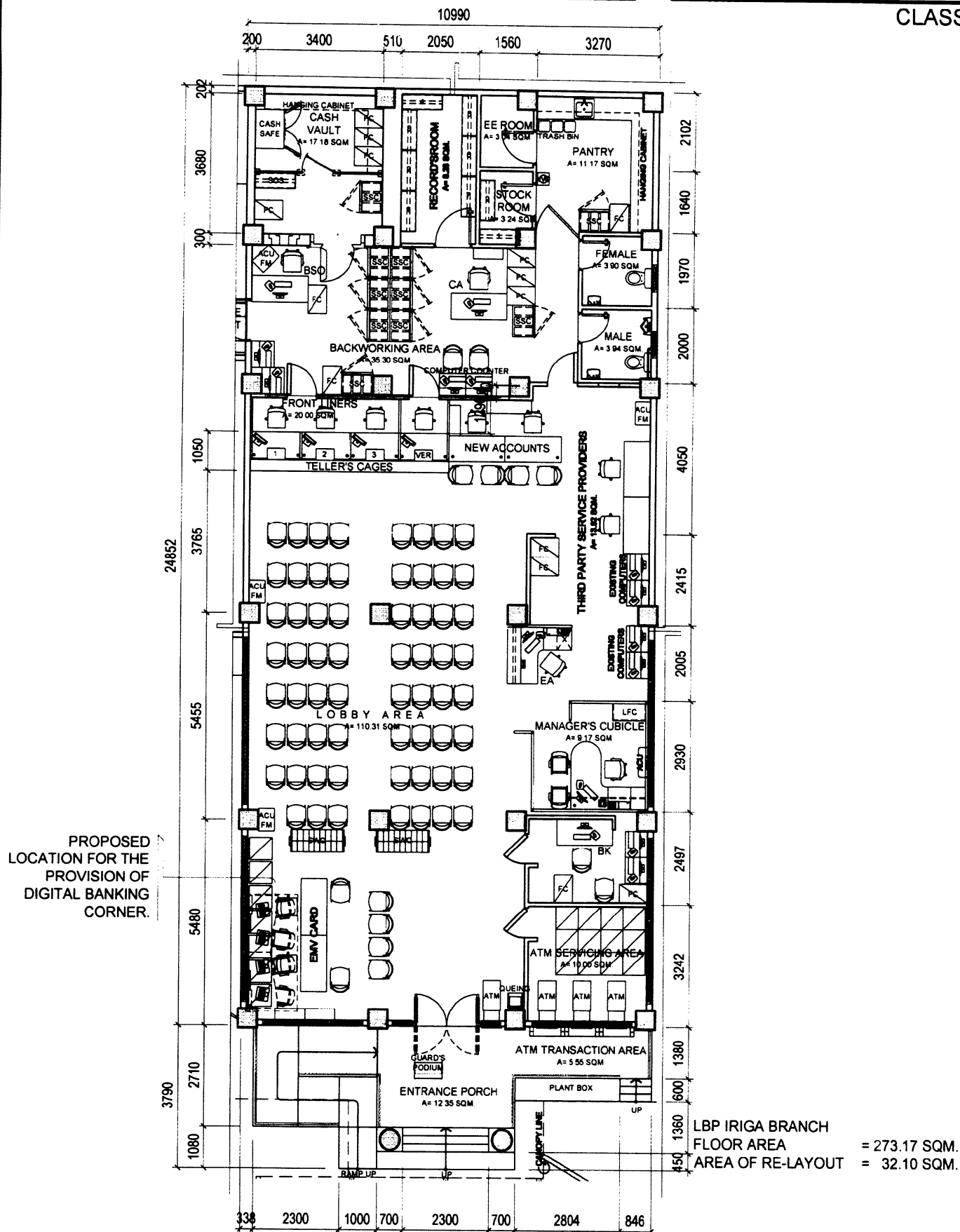

# 1 PROPOSED GROUND FLOOR PLAN

A-2 SCALE 1:140 METERS

REVISION DATE:



PROJECT TITLE:

PROPOSED LANDBANK IRIGA BRANCH  
RE-LAYOUT

LOCATION: MARK/NANCY BLDG. SANTIAGO GONZALES ST. SAN ROQUE, IRIGA CITY

CONFORME:

DATE:

DEC. 18, 2019

ARCHITECT: MARC

SHEET NO:

REVIEWED BY:

E. LAUREL

REVIEWED BY:

J. MISLANG

A  
2

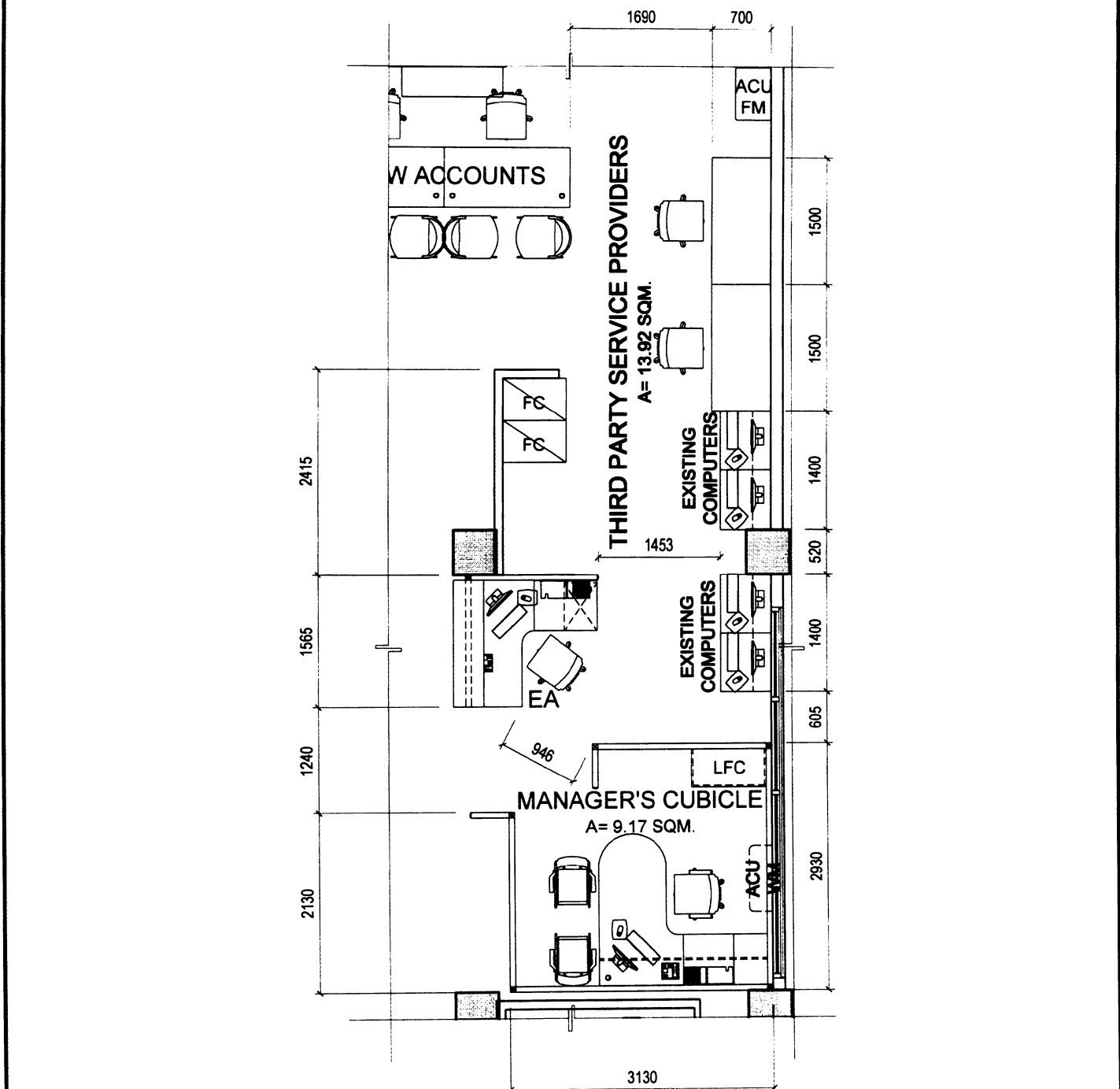

LBP IRIGA BRANCH  
FLOOR AREA = 273.17 SQM.  
AREA OF RE-LAYOUT = 32.10 SQM.

## BLOW-UP

### 1 PROPOSED FLOOR PLAN

## 1 PROPOSED FLOOR PLAN

<b>A-3</b>	<b>SCALE</b>	<b>1:40</b>	<b>METERS</b>
------------	--------------	-------------	---------------

<b>A-3</b>	<b>SCALE</b>	<b>1:40</b>	<b>METERS</b>
------------	--------------	-------------	---------------

<b>A-3</b>	<b>SCALE</b>	<b>1:40</b>	<b>METERS</b>
------------	--------------	-------------	---------------

<b>A-3</b>	<b>SCALE</b>	<b>1:40</b>	<b>METERS</b>
------------	--------------	-------------	---------------

REVISION DATE: \_\_\_\_\_

	PROJECT TITLE:	CONFORME:	DATE:	DEC. 18, 2019	ARCHITECT: MARC	SHEET NO:
	<b>PROPOSED LANDBANK IRIGA BRANCH RE-LAYOUT</b>				REVIEWED BY:	<div style="border: 1px solid black; border-radius: 50%; width: 40px; height: 40px; display: flex; align-items: center; justify-content: center; margin: 0 auto;"> <div style="text-align: center;">A</div> <div style="text-align: center;">3</div> </div>
					E. LAUREL	
					REVIEWED BY:	
LOCATION: MARK/NANCY BLDG. SANTIAGO GONZALES ST., SAN ROQUE, IRIGA CITY				J. MISLANG		

D-86



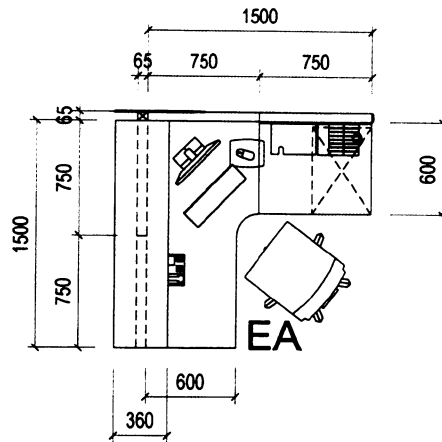

NOTE:  
STANDARD EA WORKSTATION

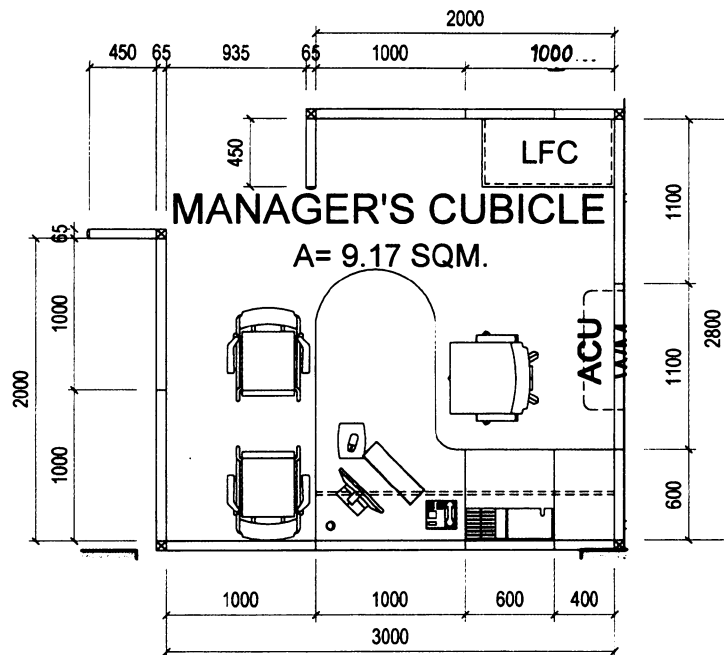

NOTE:  
MODIFIED MANAGER'S CUBICLE

**1 BLOW-UP SYSTEMS FURNITURE**  
A-4 SCALE 1:80 METERS

REVISION DATE:



PROJECT TITLE:

**PROPOSED LANDBANK IRIGA BRANCH  
RE-LAYOUT**

LOCATION: MARK/NANCY BLDG SANTIAGO GONZALES ST., SAN ROQUE, IRIGA CITY

CONFORME:

DATE:

DEC. 18, 2019

ARCHITECT: MARC

SHEET NO:

REVIEWED BY:

E. LAUREL

REVIEWED BY:

J. MISLANG

**A  
4**

D-07